

## 在 Mac OS 以無線方式安裝及連接 PIXMA G4780 打印機

### Installing PIXMA G4780 on Mac OS via WiFi connection



以下步驟及畫面僅供參考，實際操作畫面可能因裝置型號、系統或軟件版本而有所不同。

The following steps and screens are for reference only, and the actual operation screens may vary depending on the device model, system, or software version.

#### 無線設定 Wireless Setup

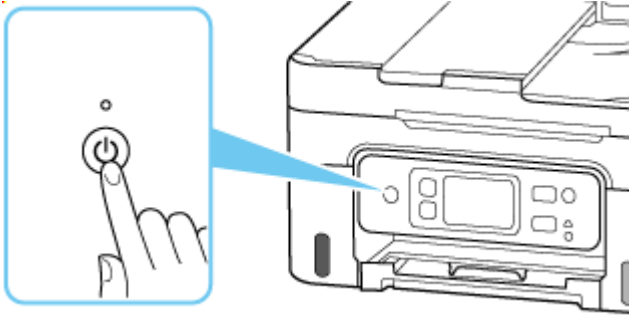
1. 確保在開始無線連接設定之前，印表機已開啟。  
如果電源開啟，電源指示燈閃爍，然後持續亮起。  
Make sure printer is turned on before starting wireless connection setup.  
If the power is on, the ON lamp flashes and then remains lit.



2. 按  (主頁)。  
根據印表機的網路連接狀態， (網路) 的外觀會有所不同。

Press  (HOME).

The appearance of  (Network) varies depending on the printer's network connection status.



3. 點選  [網路]

Tap  (Network)

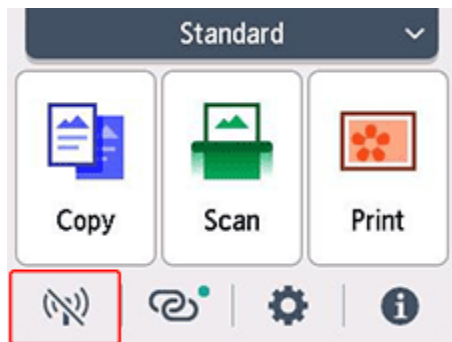

4. 點選 **Wi-Fi**

Tap **Wi-Fi**

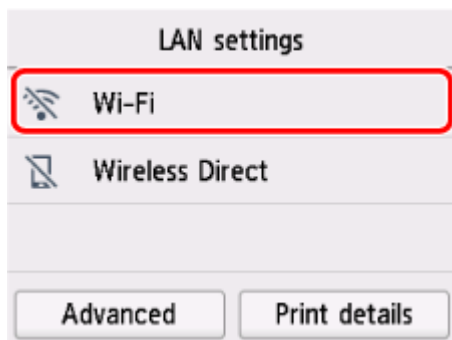

5. 點選 **Wi-Fi 設定**

Tap **Wi-Fi setup**

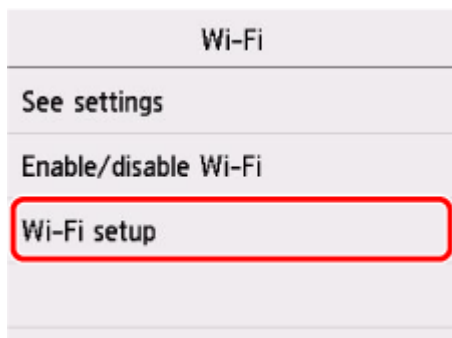

6. 點選**手動連接**

Tap **Manual connect**

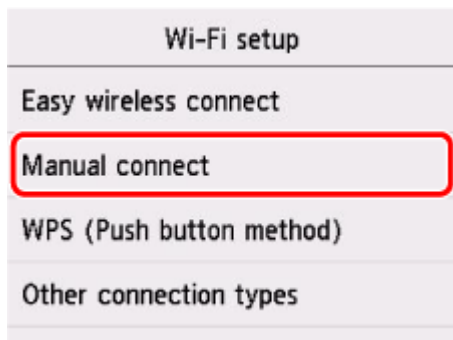

7. 點選所用無線路由器

Tap your wireless router

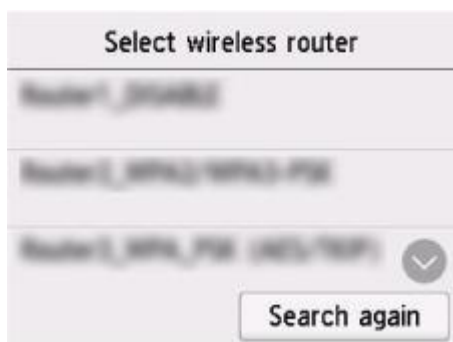

如果未找到您的路由器，請確定您的路由器設定符合以下打印機的規格：

If you do not find your router, please ensure your router setting meets the below printer requirement:

a. 頻率 Frequency: 2.4GHZ

8. 點選輸入區域

Tap the input area.

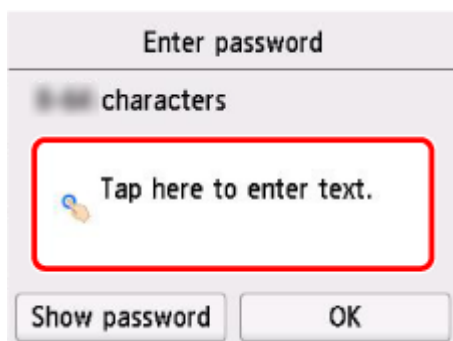

9. 輸入密碼。文字輸入區分大小寫。

關於如何輸入字元和如何變更字元類型，請參見「[輸入數字、字母和符號](#)」(在新視窗中顯示)。

Enter the password. Text entry is case-sensitive.

For how to enter characters and how to change the character type, see "[Entering Numbers, Letters, and Symbols](#)" (appears in a new window).



10. 點選 

Tap 

11. 點選 **OK**  
Tap **OK**.



12. 顯示以下螢幕時，請按 **OK** 按鈕。

When the following screen appears, press the **OK** button.

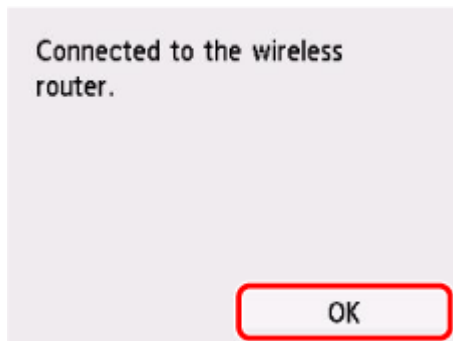

13. 選擇  (主頁)。

Select  (**HOME**).



網路連接設定完成。

The network connection setup is now complete.

連接完成後， 會出現在螢幕左上方。

Once connection is complete,  appears at the upper left of the screen.

## 下載及安裝步驟

### Driver download and Installation procedure

14. 到以下佳能網站並下載印表機的驅動程式  
Go to below Canon webpage and download the printer driver  
<https://hk.canon/en/support/pixma%20g4780/model>

15. 選擇並下載以下檔案  
Choose and download below file

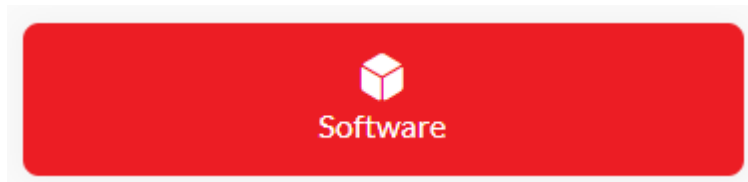

#### Master Setup (Mac)

<https://hk.canon/en/support/0200641904>

16. 按網頁內的 [ Download ], 下載完成後開啟該檔案安裝  
Click [Download] in the webpage, and then execute the file after download was completed

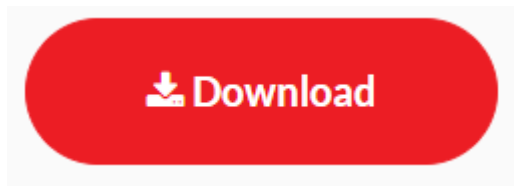

17. 按 [ Master Setup ]  
Click [Master Setup]



18. 請輸入電腦帳號密碼，再按〔安裝輔助程式〕

Please type in the password of computer account, then click [Install Helper]



19. 按〔開始設定〕

Press [Start Setup]



20. 請等候  
Please wait



21. 按〔是〕  
Click [Yes]





22. 閱後按〔同意〕或〔不同意〕

Click [Agree] or [Do not agree] after reading

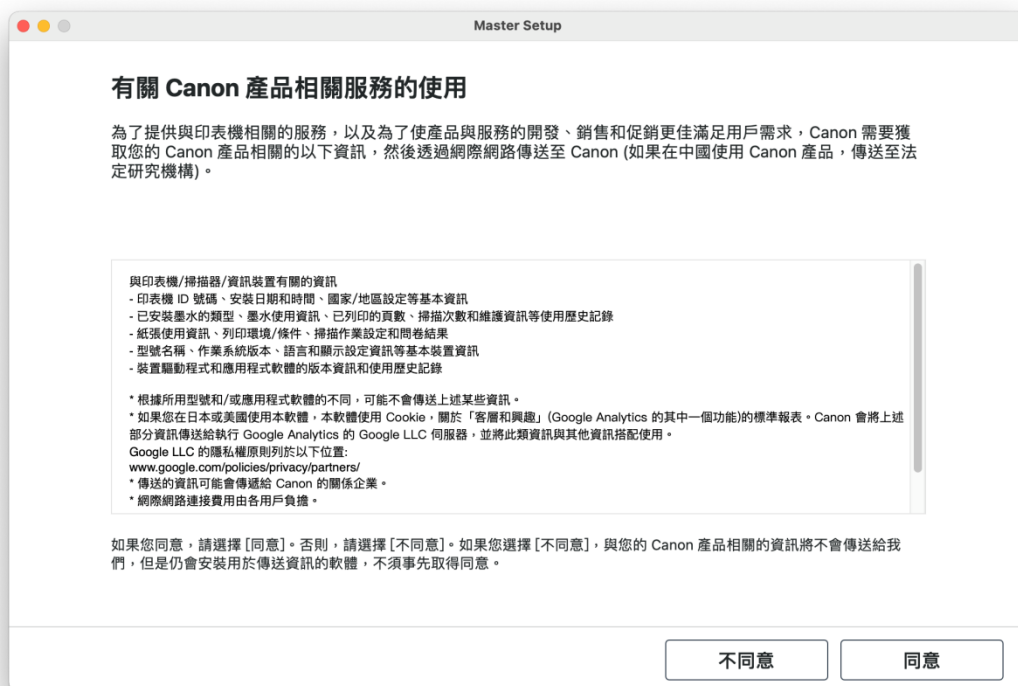

23. 請等候

Please wait

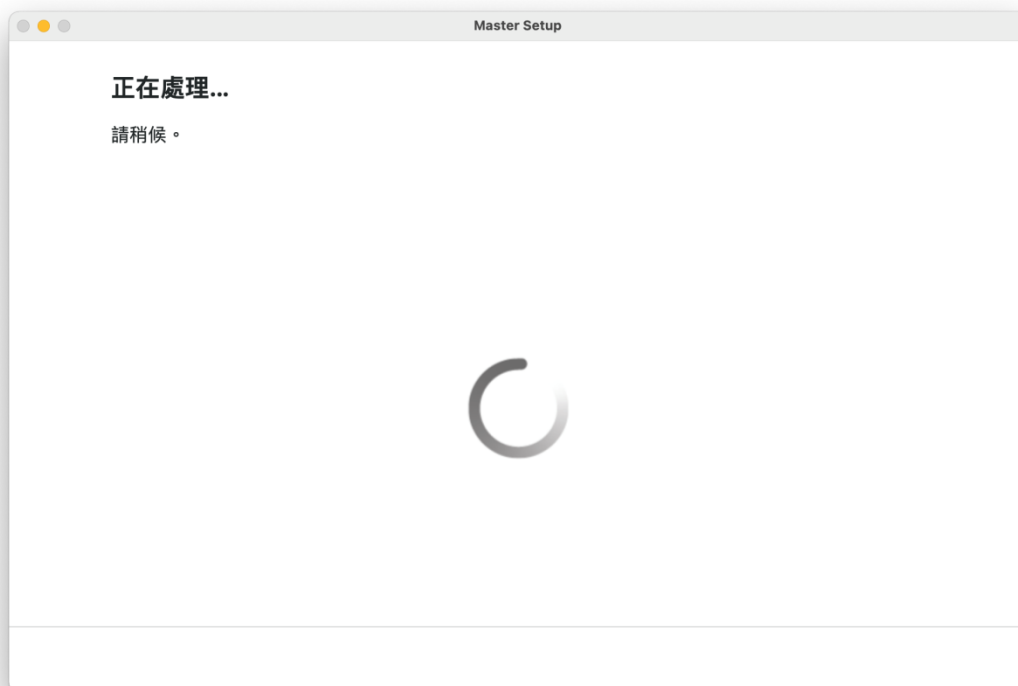

24. 確認印表機電源已開啟，再按〔下一步〕  
Confirm power on the printer, then click [Next]



25. 請等候  
Please wait

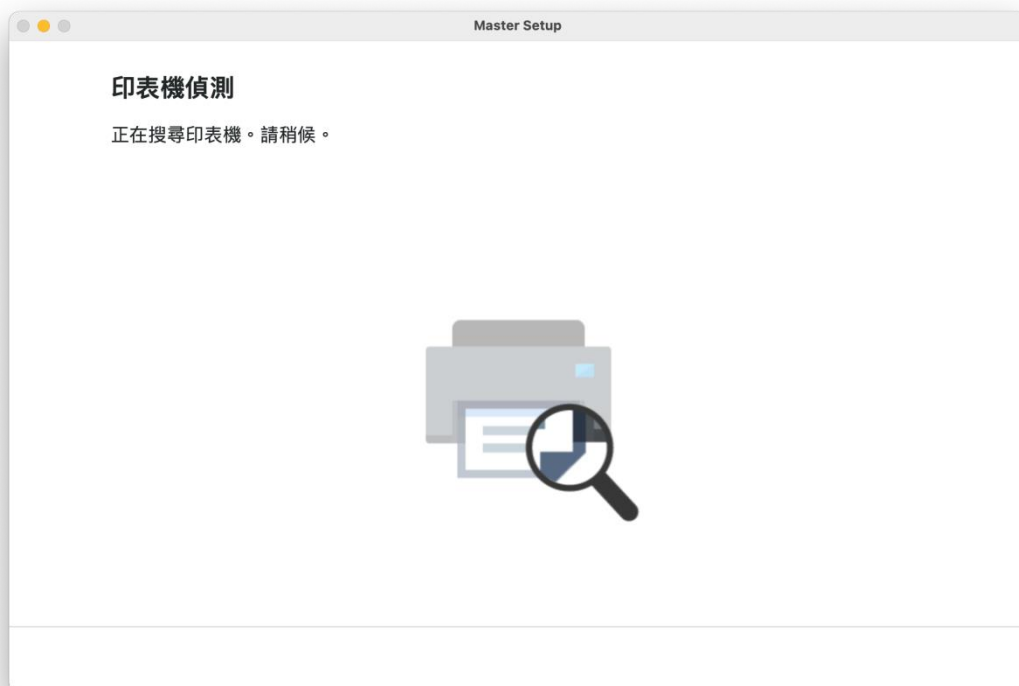

26. 從清單中選擇印表機，再按〔下一步〕  
Choose the printer from the list, then click [Next]



27. 按〔繼續〕  
Click [Continue]



28. 成功偵查印表機後請等候安裝  
Please wait for install after detect the printer



29. 請等候下載及安裝  
Please waiting for download and install



30. 按〔新增印表機〕  
Click [Add Printer]

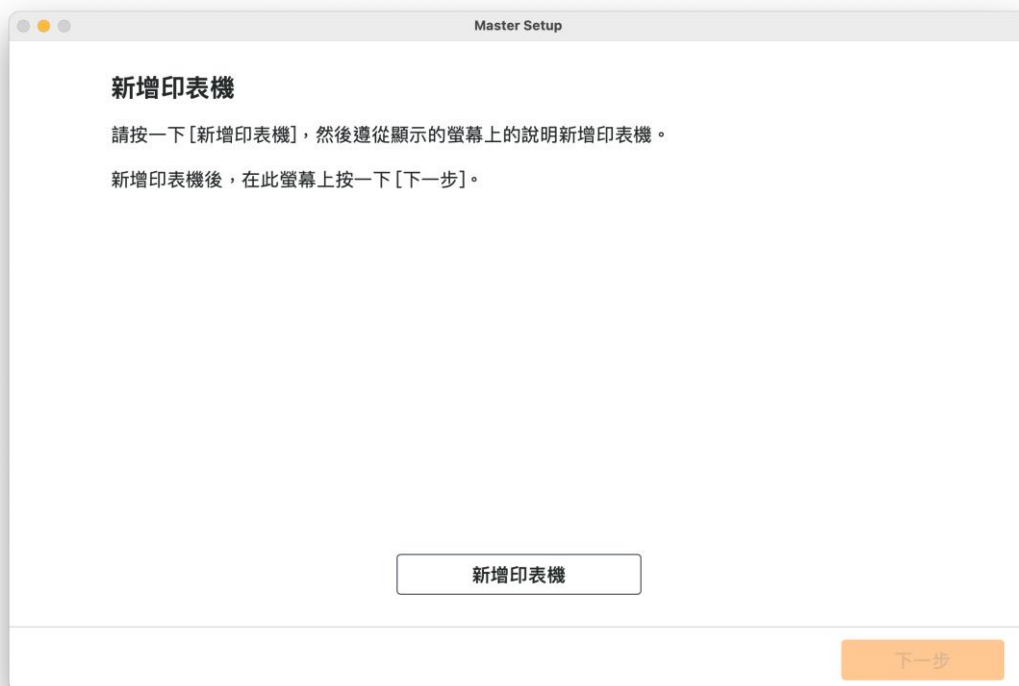

31. 選擇〔Canon G4080 series〕，再按〔加入〕  
Choose [Canon G4080 series], then click [Add]

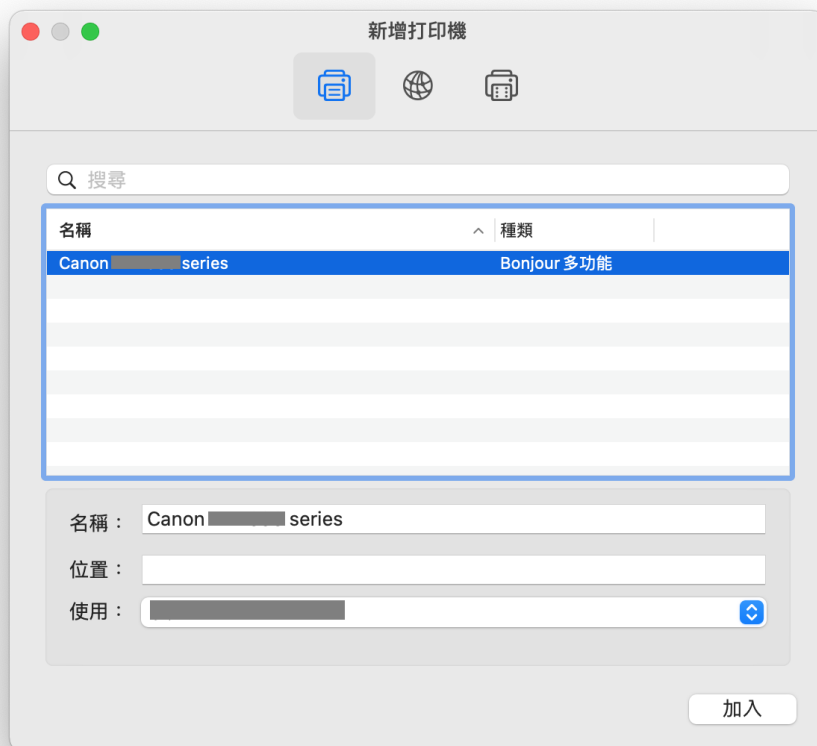

32. 請等候  
Please wait

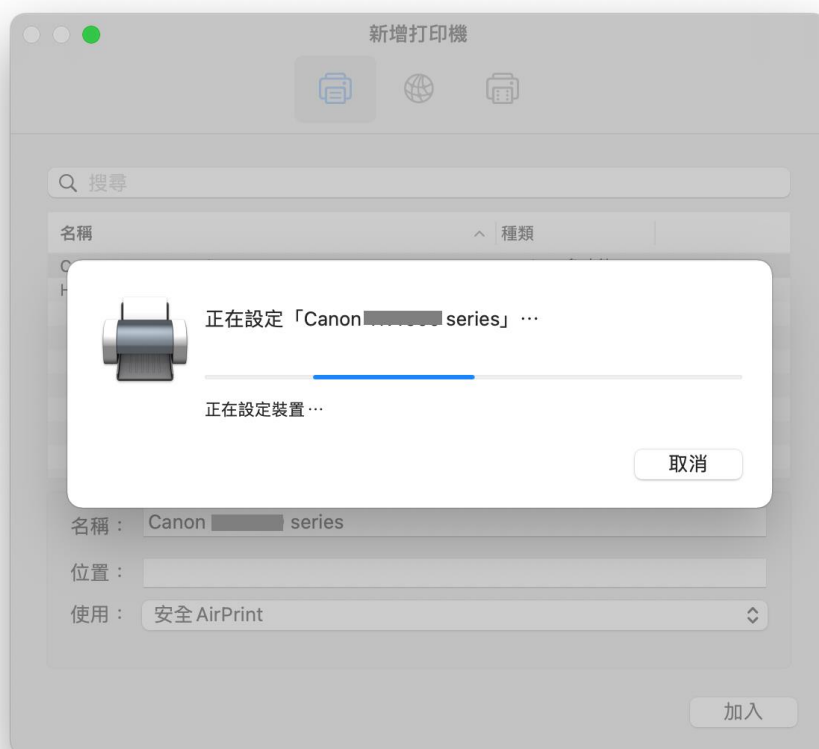

33. 按 [ 下一步 ]  
Click [Next]



34. 按〔下一步〕  
Click [Next]



35. 請等候  
Please wait



36. 按〔下一步〕  
Click [Next]

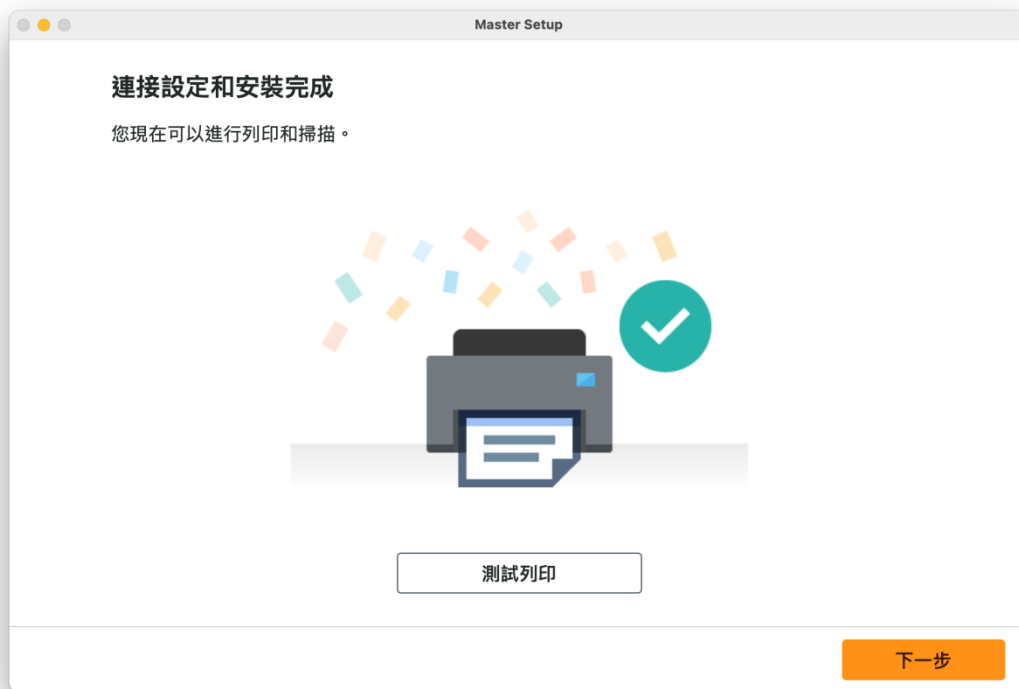

37. 安裝完成  
Driver installation was completed



-完-  
-End-