

## 在 Windows 以 USB 方式安裝及連接 MAXIFY GX1070 打印機

### Installing MAXIFY GX1070 on Windows via USB connection

**\*\*注意: 安裝驅動程式前請勿接駁 USB 線，以免系統發生錯誤\*\***

**\*\* Please don't plug the USB cable until the driver asked to do so\*\***

以下步驟及畫面僅供參考，實際操作畫面可能因裝置型號、系統或軟件版本而有所不同。

**The following steps and screens are for reference only, and the actual operation screens may vary depending on the device model, system, or software version.**

#### 下載及安裝步驟

#### Driver download and Installation procedure

1. 到以下佳能網站並下載印表機的驅動程式  
Go to below Canon webpage and download the printer driver  
<https://hk.canon/en/support/MAXIFY%20GX1070/model>
2. 選擇並下載以下檔案  
Choose and download below file  
**GX1070 MP Drivers Ver.1.xx (Windows)**
3. 按上面網頁內的〔下載〕，下載完成後開啟該檔案安裝  
Click [Download] in the webpage above, and then execute the file after download was completed
4. 按〔下一步〕  
Click [Next]



5. 選擇〔亞洲〕，按〔下一步〕

Select [Asia]; click [Next]

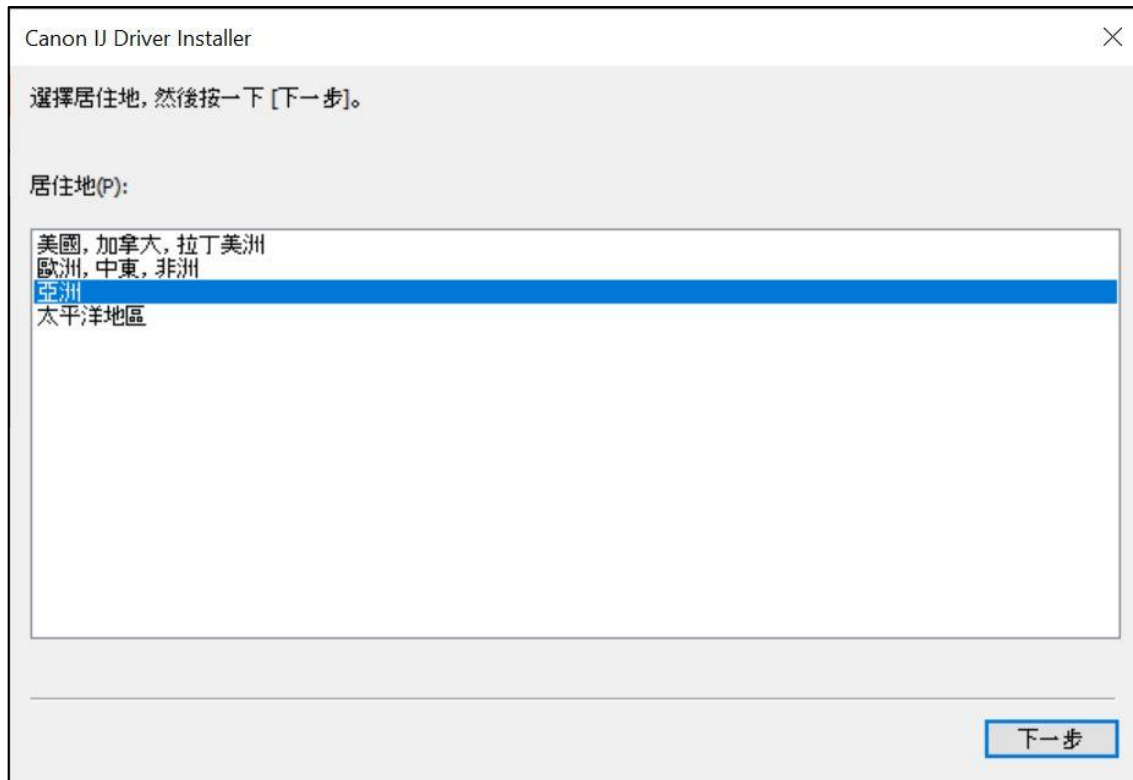

6. 按〔是〕

Click [Yes]



7. 如下圖所示，連接 USB 線，然後在清單中選擇連接方法為 USB 的打印機，按〔 下一步 〕  
As the illustration below, connect the USB cable, then select the printer with USB connection method from the list, click [Next]

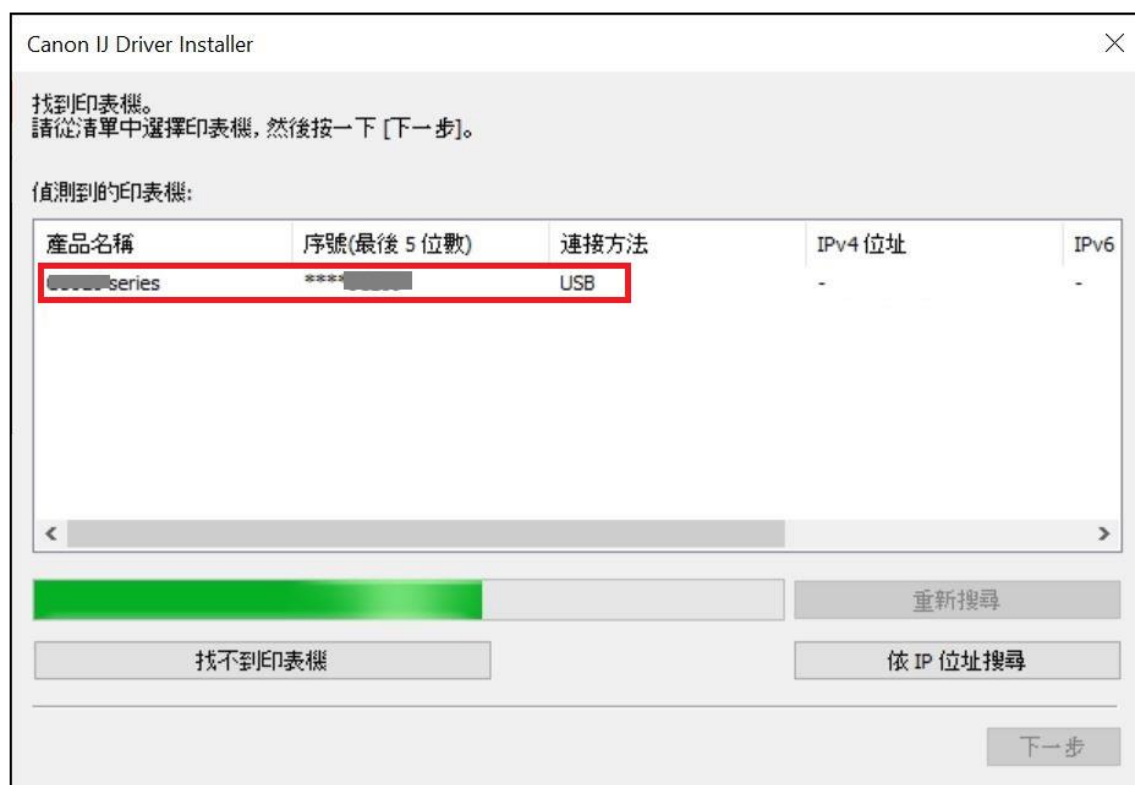
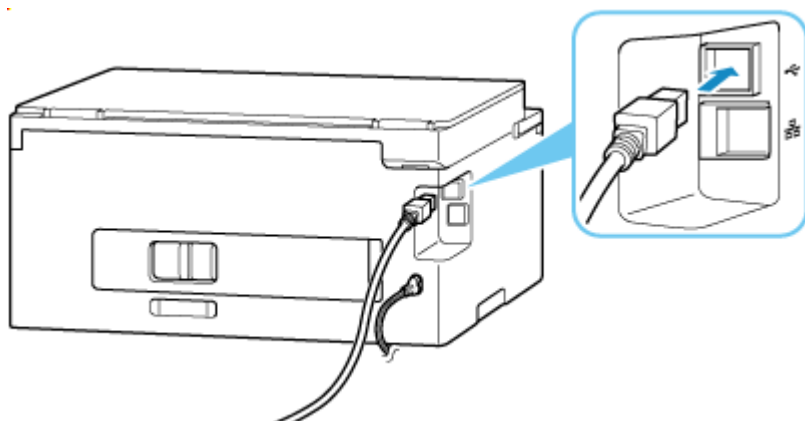

8. 正在安裝印表機驅動程式，請稍候  
Installing the driver, please wait

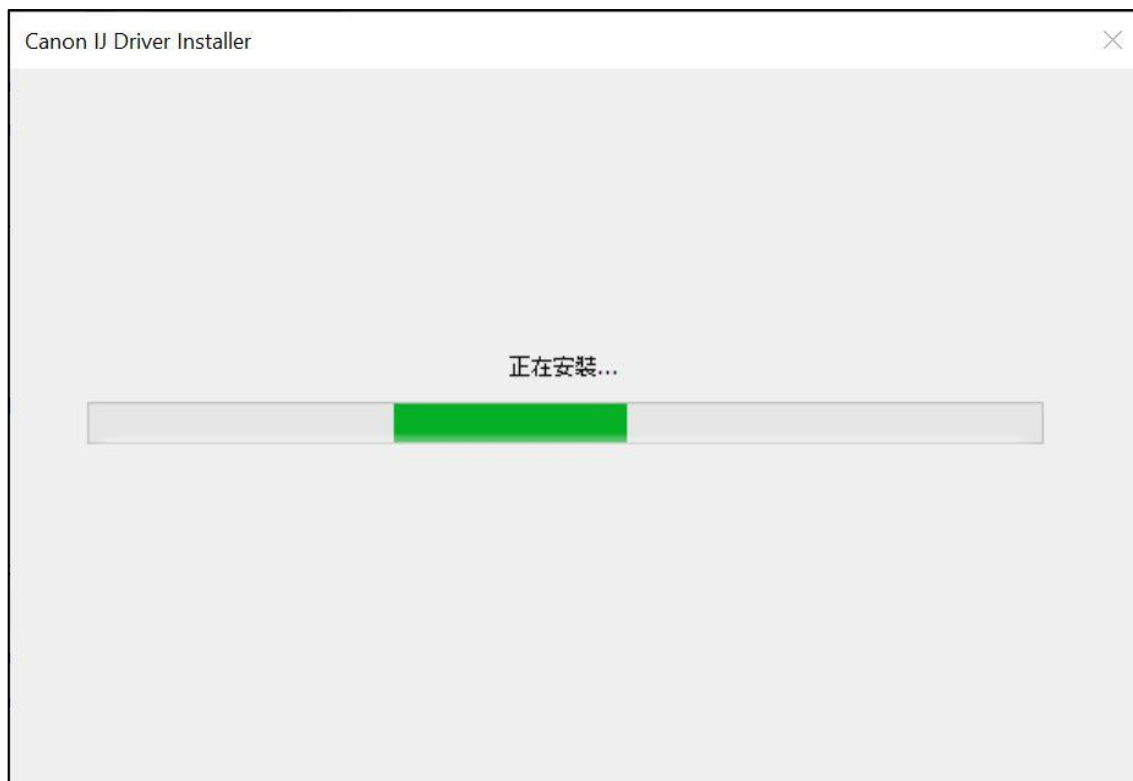

9. 安裝完成，按〔結束〕  
Driver installation was completed; click [Finish]

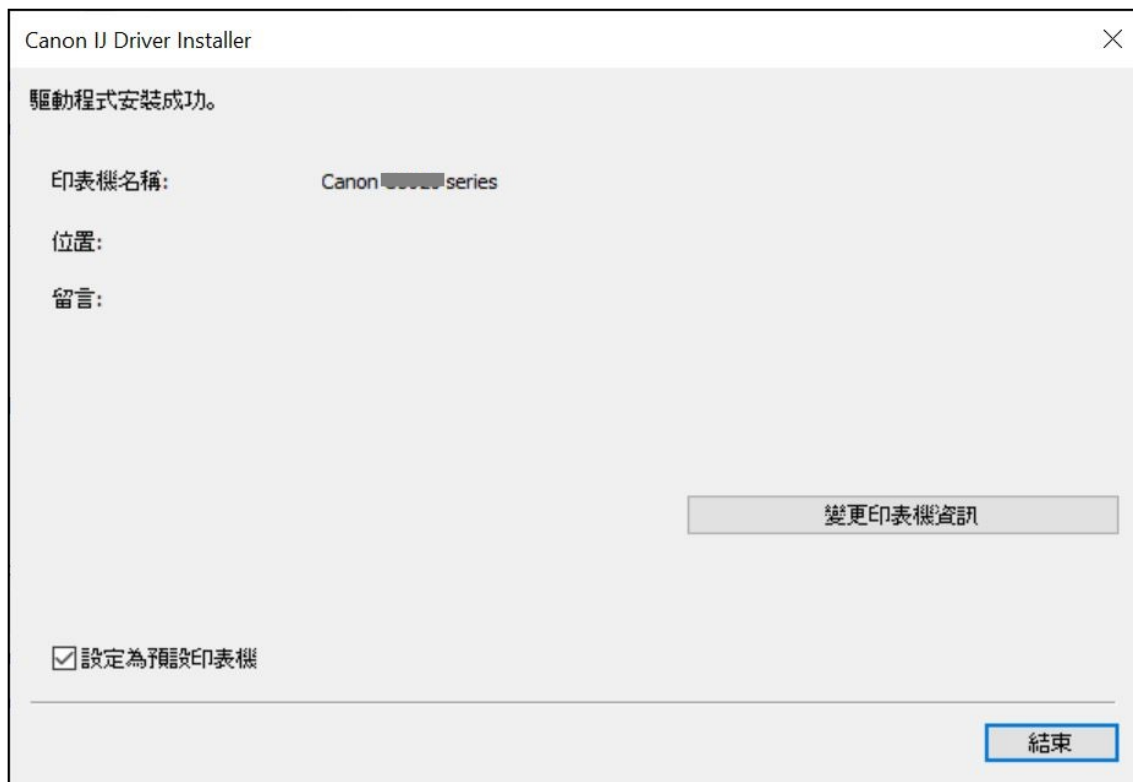

-完-  
-End-