

如何列印網路設定資料*沒有螢幕 / 螢幕上不能查看網路設定資料型號

How to print out Network Configuration Page* For no Screen / Screen cannot check network configuration model

需載入一至兩張A4 / Letter大小普通紙張

Load a sheet of A4 or Letter sized plain paper

MG2970

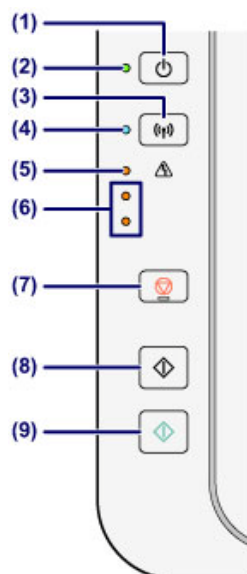

按著**停止**按鈕 (7) 直至錯誤指示燈 (5) 閃爍 15 次後放手

Press the **Stop** button (7) until the error alarm lamp (5) flashes 15 times and then release the button

iP110

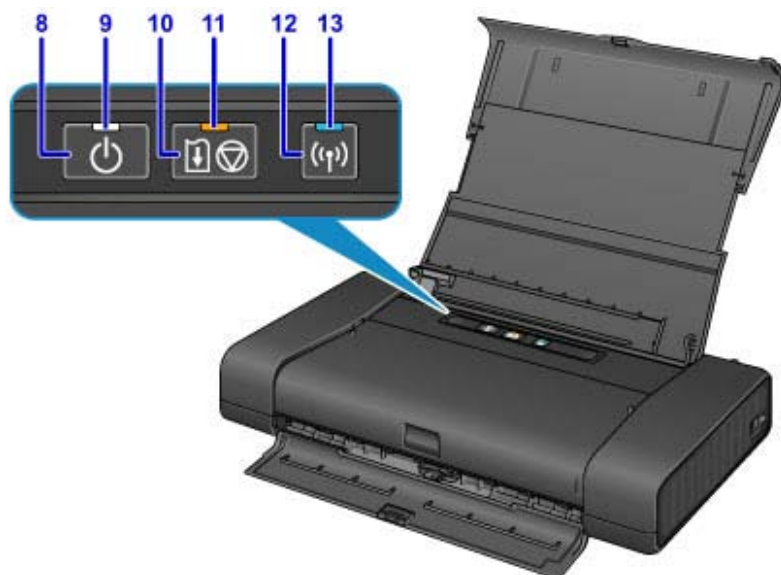

按著**重試/取消**按鈕 (10) 直至錯誤指示燈 (11)閃爍 6 次後放手

Press the **Resume/Cancel** button (10) until the error alarm lamp (11) flashes 6 times and then release the button

MG3570

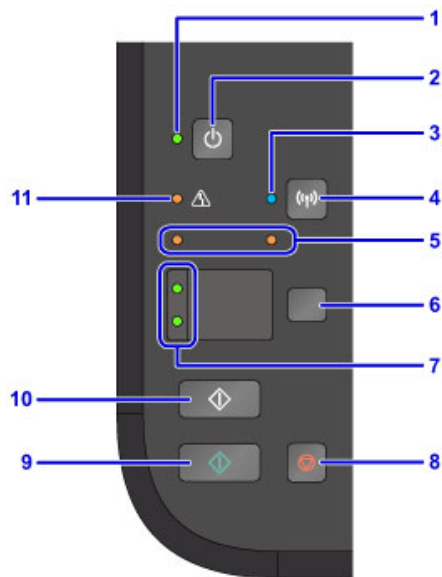

按著**停止**按鈕 (8) 直至錯誤指示燈 (11) 閃爍 15 次後放手

Press the **Stop** button (8) until the error alarm lamp (11) flashes 15 times and then release the button

MG3670

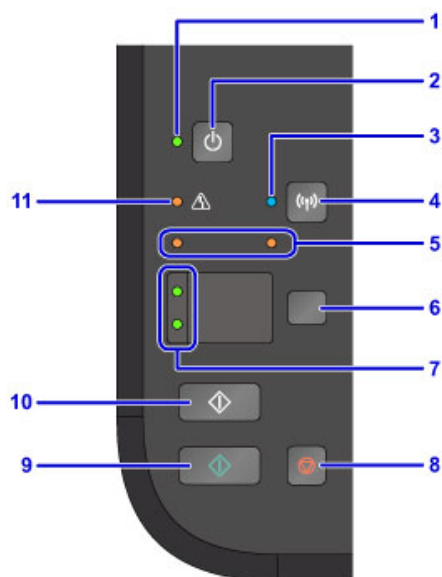

按著打印機上的**Wi-Fi**按鈕 (4) 直至電源燈 (1) 開始閃爍後放手，然後再按 1 次**Wi-Fi**按鈕 (4)

Press **Wi-Fi** button (4) until power indicator (1) starts flashing, then release **Wi-Fi** button and press **Wi-Fi** button (4) 1 time

iP8770



按著**重試/取消**按鈕 (11) 直至錯誤指示燈 (10)閃爍 6 次後放手
Press the **Resume/Cancel** button (11) until the error alarm lamp (10) flashes 6 times and then release the button

iX6870

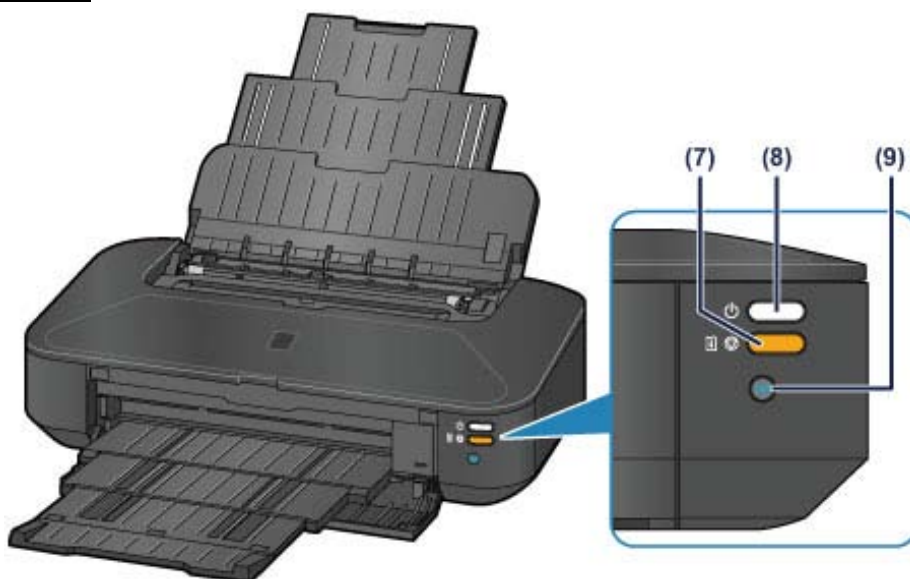

按著**重試/取消**按鈕 (7) 直至錯誤指示燈 (7)閃爍 6 次後放手
Press the **Resume/Cancel** button (7) until the error alarm lamp (7) flashes 6 times and then release the button

G3000

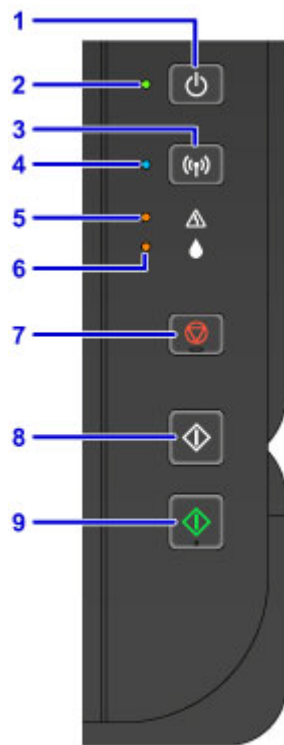

按著打印機上的**Wi-Fi**按鈕 (3) 直至電源燈 (2) 開始閃爍後放手，然後再按 1 次**Wi-Fi**按鈕 (3)

Press **Wi-Fi** button (3) until power indicator (2) starts flashing, then release **Wi-Fi** button and press **Wi-Fi** button (3) 1 time

MX497 / MX537

1. 按設定按鈕

Press the **Setup** button



2. 使用 ◀▶ 按鈕選擇 裝置設定 (MX497) / 設備設定 (MX537)，然後按 OK 按鈕。

Use the ◀▶ button select **Device settings**, then press the **OK** button

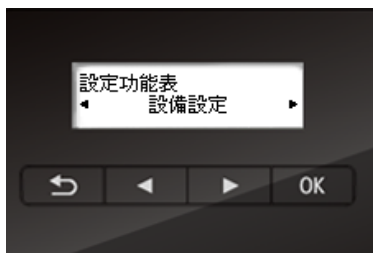

3. 使用 ◀▶ 按鈕選擇 LAN 設定，然後按 OK 按鈕。

Use the ◀▶ button to select **LAN settings**, then press the **OK** button



4. 使用 ◀▶ 按鈕選擇列印 LAN 詳細資訊，然後按 OK 按鈕。

Use the ◀▶ button to select **Print LAN details**, then press the **OK** button



LBP6030w / LBP6230dn



按著打印機上的紙張按鈕 3 秒

Press **Paper** button hold for 3 seconds

LBP6680x

1. 按 [] **Utility**

Press **Utility** 

2. 選擇 **Network Status Print**，按 **OK**

Select **Network Status Print** using [▲] or [▼], and then press **OK**.

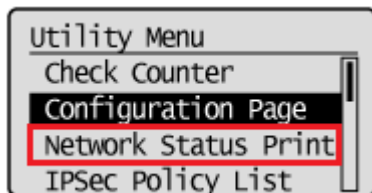

3. 選 **YES**，按 **OK**

Select **Yes**, and then press **OK**

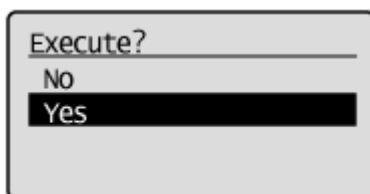

LBP8780x

1. 按 ，選 **Network Status Print**，按 **OK**

Press , choose **Network Status Print**, and then press **OK**

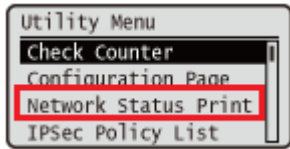

2. 選 **Yes**，按 **OK**

Choose **Yes**, and then press **OK**

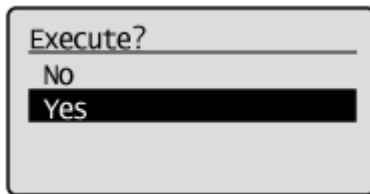

LBP8100n

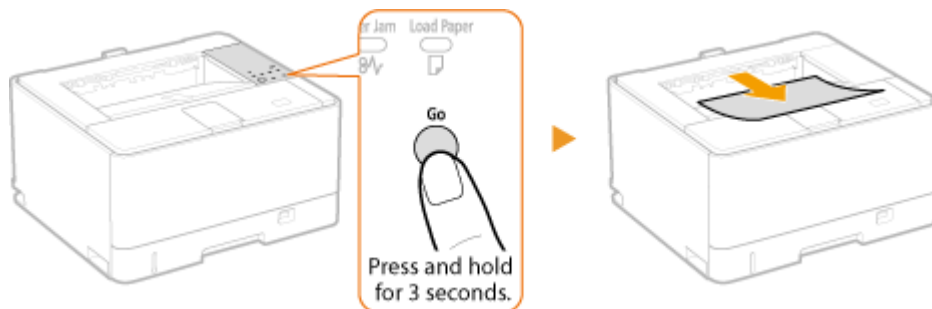

按著打印機上的 **Go** 按鈕 3 秒

Press **Go** button hold for 3 seconds