

MB5070 安裝 Windows 8 透過有線 LAN 連線連接印表機之驅動程式步驟

把以太網路線連接印表機，並於印表機上作以下設定：

變更有線LAN連線

Change Wired LAN active

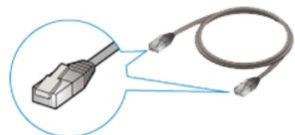

需要乙太網路纜線(另行購買)
Need an Ethernet cable (sold separately)

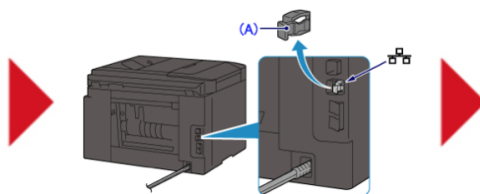

取下位於印表機背部左側的連接埠的蓋子 (A)
Remove the Cap (A) from the port located on the left side at the back of the printer

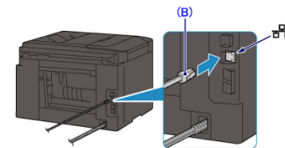

使用乙太網路纜線 (B) 連接印表機和網路設備 (路由器等)
注意：請勿連接至任何其他連接埠
Connect the printer and a network device (router, etc.) with an Ethernet cable (B)
CAUTION: Do not connect to any other port



選擇“設定”
Choose “Setup”

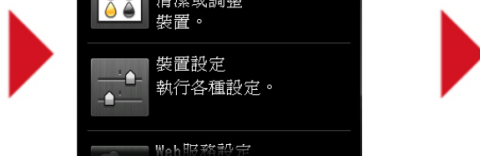

選擇“裝置設定”
Choose “Device Setting Perform various settings”



選擇“LAN設定”
Choose “LAN settings”



選擇“變更LAN”
Choose “Change LAN”



選擇“有線LAN連線”
Choose “Wired LAN active”



顯示“變更LAN有線LAN連線”
Show “Change LAN Wired LAN active”

完成後點擊以下連結下載有關之驅動程式

https://hk.canon/zh_HK/support/0100608501/5

下載及安裝步驟

1. 按一下「下載」。下載完成後開啟該檔案安裝



2. 按「下一步」



3. 按「下一步」

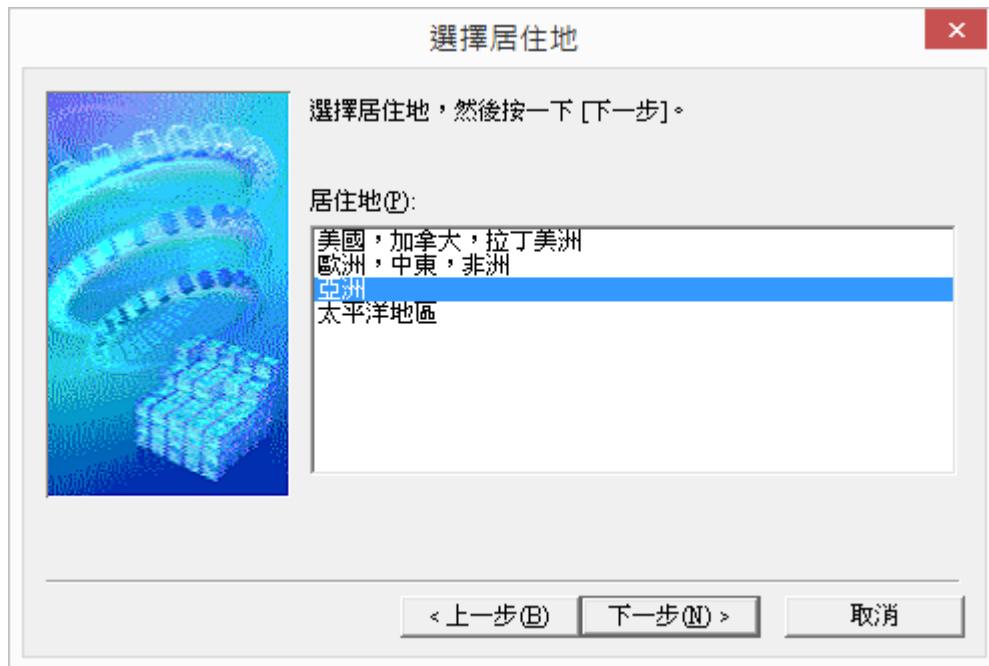

4. 按「是」

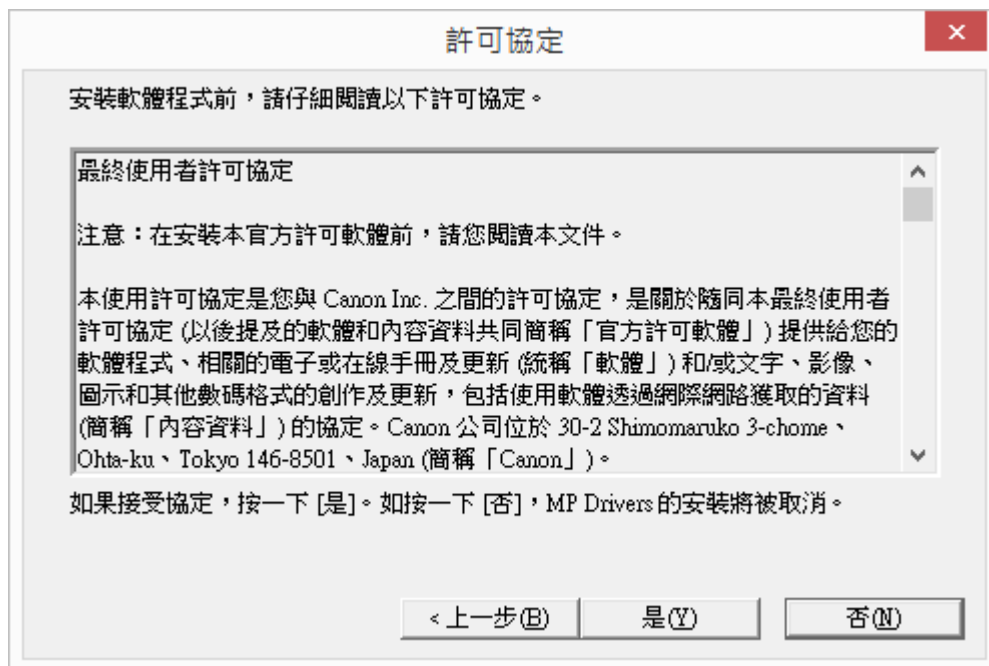

5. 正在安裝，請稍候

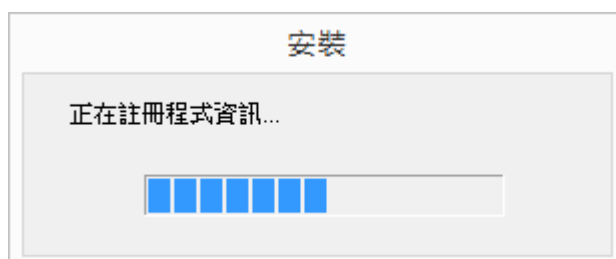

6. 選擇「透過有線 LAN 連接使用印表機 (I)」



7. 正在搜尋網路上的印表機



8. 按「下一步」



9. 正在註冊印表機驅動程式，請稍候

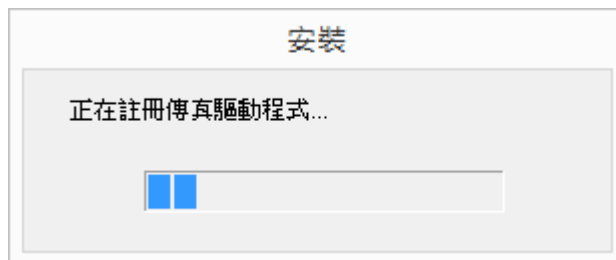

10. 按「完成」



-完-