

**LBP226dw 在 MAC OSX 10.14 透過有線 LAN 連線連接印表機之驅動程式步驟**  
**Driver installation procedure for LBP226dw in MAC OSX 10.14(Via LAN)**

1. 先將打印機連接到網路，詳細可參考以下步驟  
(Connect the printer to a Wired LAN)
2. 在主畫面中選「功能表」  
(Select “Menu” in the Home Screen)
3. 選「參數選擇」>「網路」  
(Select “Preference” > “Network”)

若顯示 PIN 碼輸入畫面，請使用數字鍵輸入 PIN 碼，然後選「套用」  
(If a screen require for enter PIN is display, enter the PIN with the numeric keys and tap “Apply”)

4. 點選「有線/無線區域網路」，然後選「有線區域網路」  
(Select “Select Wired/Wireless LAN” and select “Wired LAN”)
5. 連接區域網路纜線 (Connect a LAN cable)

使用區域網路纜線將本機連接到路由器

推入接頭，直至聽到喀嗒聲

(Connect the machine to a router by using a LAN cable, push the connector in until it clicks into place)

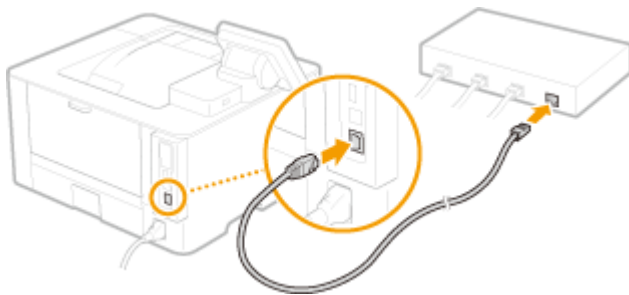

等待約 2 分鐘 (Wait approximately 2 minutes)

等待時，會自動設定 IP 位址 (While you wait, the IP address is set automatically)

## 下載及安裝步驟

### Driver download and installation procedure

1. 到佳能網站 <https://hk.canon/en/support/imageclass%20lp226dw/model>，下載印表機的驅動程式  
Go to: <https://hk.canon/en/support/imageclass%20lp226dw/model>, download the printer driver
2. 選擇並下載以下檔案  
Choose and download below file:  
  
- 打印機驅動程式 / Printer Driver  
**UFR II/UFR II LT Printer Driver & Utilities for Macintosh Vxx.xx.x**
3. 下載完成後開啟檔案 [ mac-UFR II-LIPSLX-vxxxxx-xx.dmg ]，按「UFR II\_LT\_LIPS\_LX\_Installer.pkg」  
Open the downloaded file [ mac-UFR II-LIPSLX-vxxxxx-xx.dmg ] , press  
“UFR II\_LT\_LIPS\_LX\_Installer.pkg”

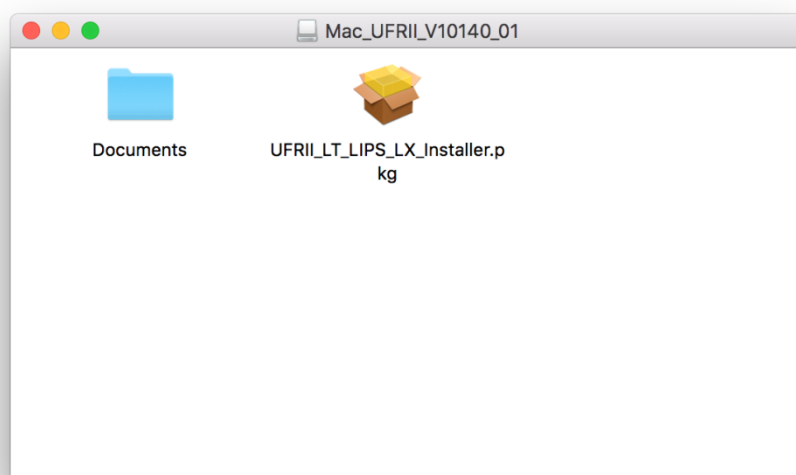

4. 按「繼續」  
Click “Next”



5. 按「繼續」然後按「同意」  
Click “Next” and then click “Agree”



- 按「安裝」  
Click "Install"

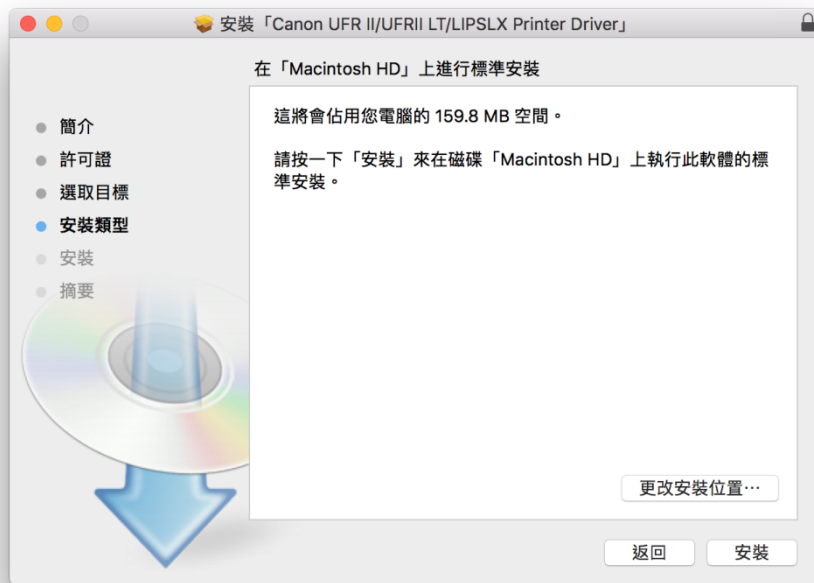

- 等待安裝程序完成  
Waiting for the installation progress

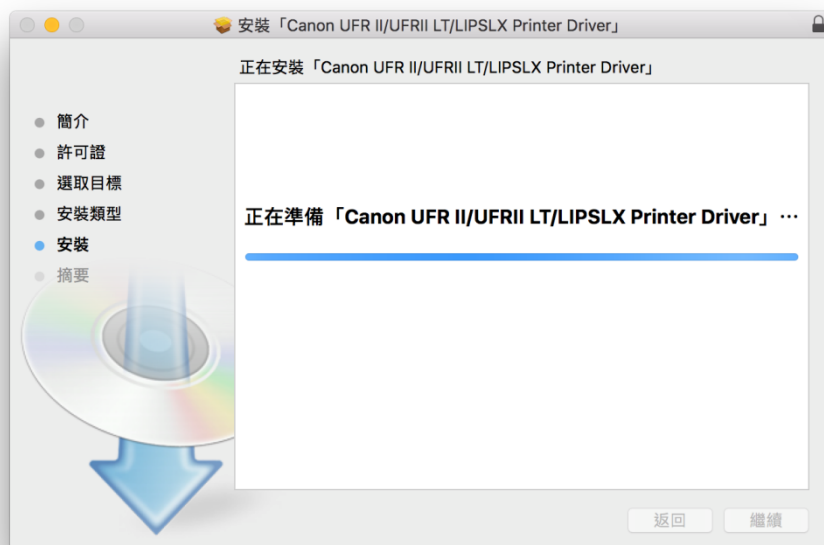

8. 按「關閉」  
Click “Close”



9. 完成安裝驅動程式後需新增印表機，到「系統偏好設定」，選「印表機與掃描器」  
Go to “System Preferences” and open “Printer and Scanner”



10. 選取左下角「+」按鈕，選「加入印表機或掃描器」  
Click the “+” button and choose “Add printer or Scanner”



11. 名稱選擇「Canon LBP226」，種類選擇「Bonjour」，「使用」選擇「Canon LBP226」，然後按「加入」，新增印表機  
Choose “Canon LBP226” with Kind “Bonjour”, and “Canon LBP226” in “Use”, then click “Add”



12. 完成以上設定後已可使用印表機作打印功能  
Setup completed. Print functions are ready to use

-完-  
-End-