

LBP654Cx 在 MAC OSX 10.12 透過有線 LAN 連線連接印表機之驅動程式步驟 Driver installation procedure for LBP654Cx in MAC OSX 10.12(Via LAN)

先將打印機連接到網路，詳細可參考以下步驟

Connect printer to network router first, refer to following procedure

1. 開啟印表機

Switch on the Printer

2. 在主畫面中點選「功能表」

Tap "Menu" in the Home Screen



3. 點選「參數選擇」

Tap "Preferences"

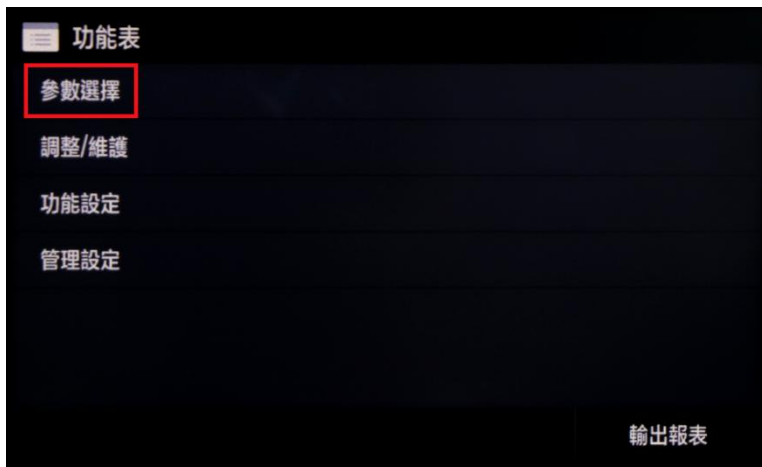

4. 點選「網路」

Tap “Network Settings”

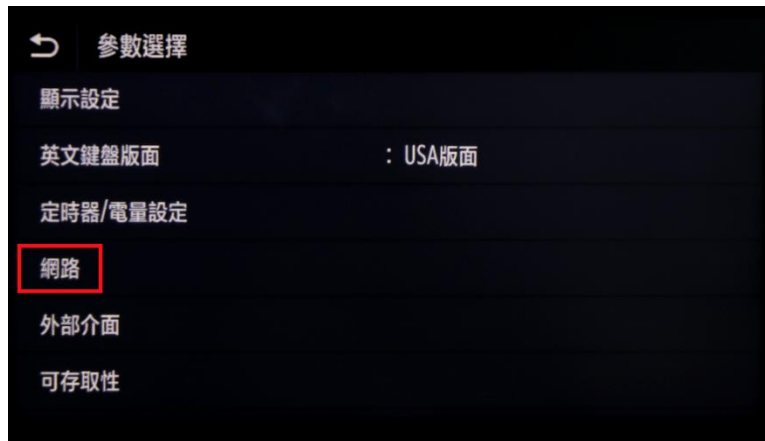

5. 點選「選擇有線 / 無線區域網路」

Tap “Select Wired / Wireless LAN”



6. 點選「有線區域網路」

Tap “Wired LAN”

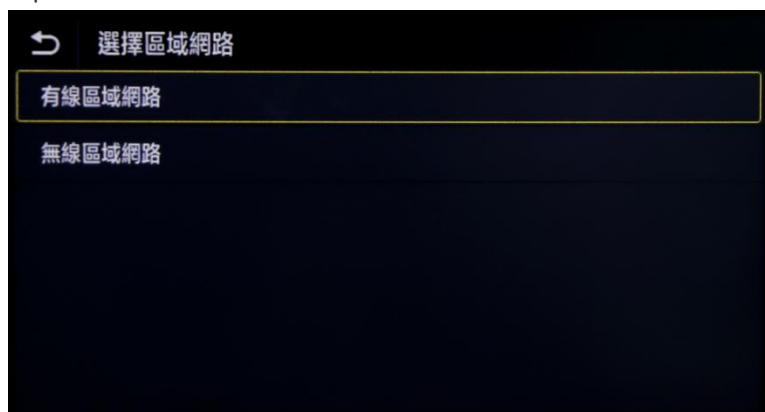

7. 使用區域網路纜線將本機連接到路由器
推入接頭，直至聽到喀嗒聲
Connect the machine to a router by using a LAN cable, push the connector in until it clicks into place

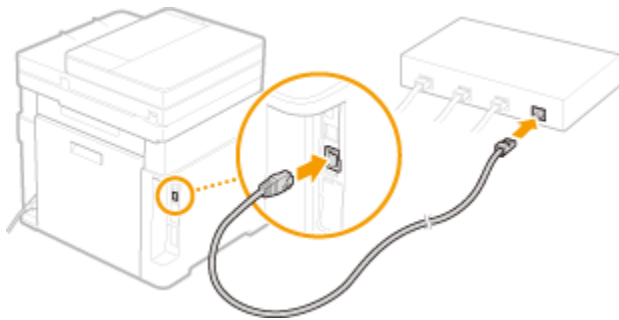

等待約 2 分鐘，直到本機的 IP 位址設定完成

Wait approximately 2 minutes until the IP address settings of the machine are completed

下載及安裝步驟

Driver download and installation procedure

8. 到佳能網站 <https://hk.canon/en/support/imageCLASS%20LBP654Cx/model>，下載印表機的驅動程式

Go to: <https://hk.canon/en/support/imageCLASS%20LBP654Cx/model>, download the printer driver

9. 選擇並下載以下檔案

Choose and download below file

- 打印機驅動程式 / Printer Driver

[UFR II/UFRII LT Printer Driver & Utilities for Macintosh Vxx.xx.x](#)

10. 下載完成後開啟檔案 [Mac_UFR11_VXXXXXX.dmg] ，按 [UFR11_LT_LIPS_LX_Installer.pkg]
Open the downloaded file [Mac_UFR11_VXXXXXX.dmg] , press “UFR11_LT_LIPS_LX_Installer.pkg”

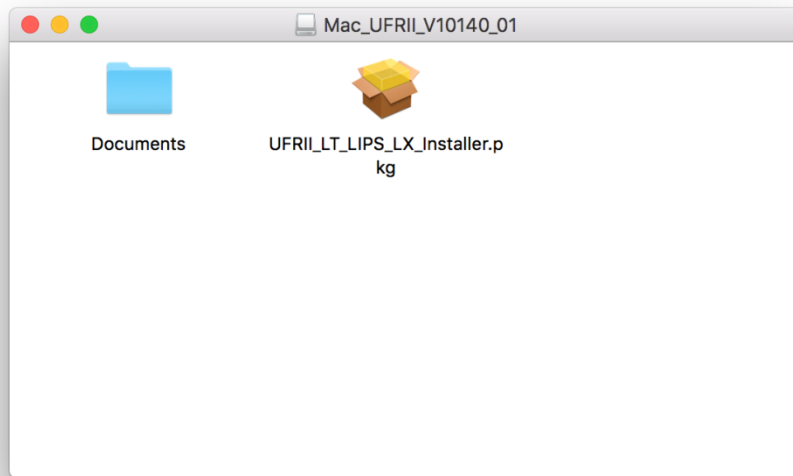

11. 按 [繼續]
Click “Next”



12. 按「繼續」然後按「同意」
Click "Next" and then click "Agree"



13. 按「安裝」
Click "Install"

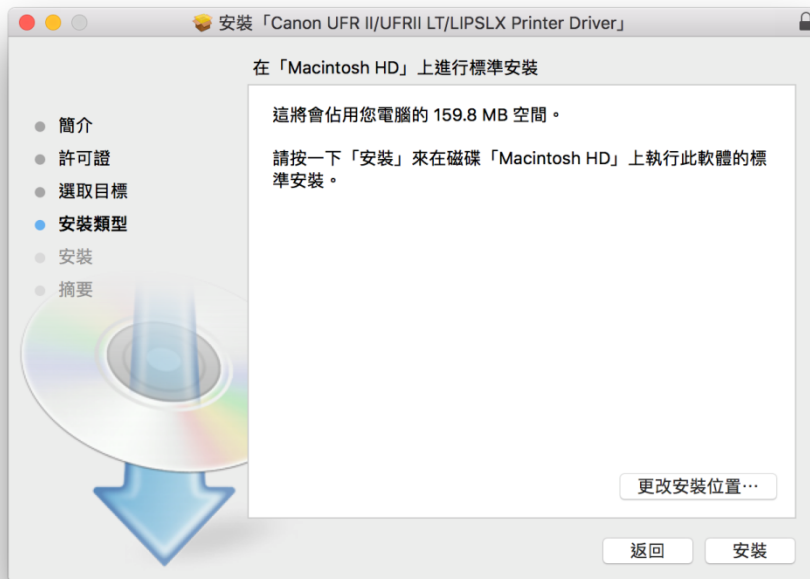

14. 等待安裝程序完成
Waiting for the installation progress

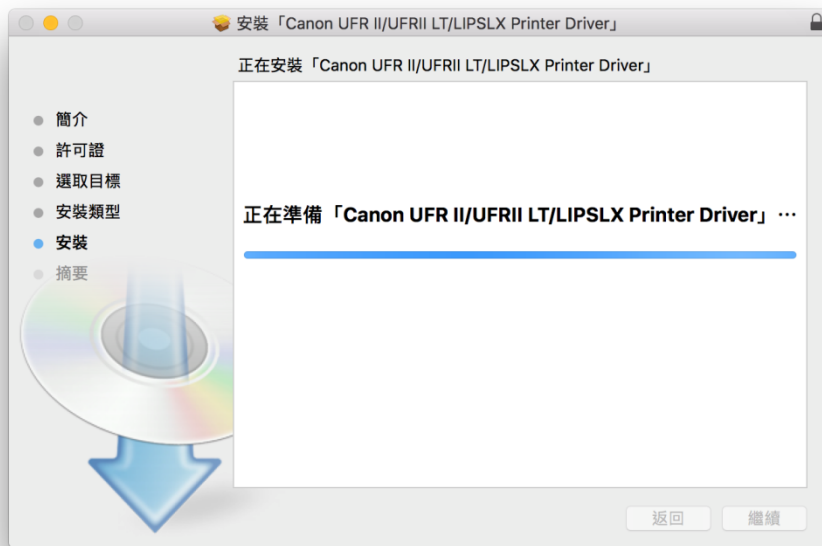

15. 按「關閉」
Click "Close"



16. 完成安裝驅動程式後需新增印表機，到「系統偏好設定」，選「印表機與掃描器」
Go to “System Preferences” and open “Printer and Scanner”



17. 選取左下角「+」按鈕，選「加入印表機或掃描器」
Click the “+” button and choose “Add printer or Scanner”



18. 名稱選擇「Canon LBP653C/654C」，種類選擇「Bonjour」，「使用」選擇「Canon LBP653C/654C」，然後按「加入」，新增印表機
Choose “Canon LBP653C/654C” with Kind “Bonjour”, and “Canon LBP653C/654C” in “Use”, then click “Add”

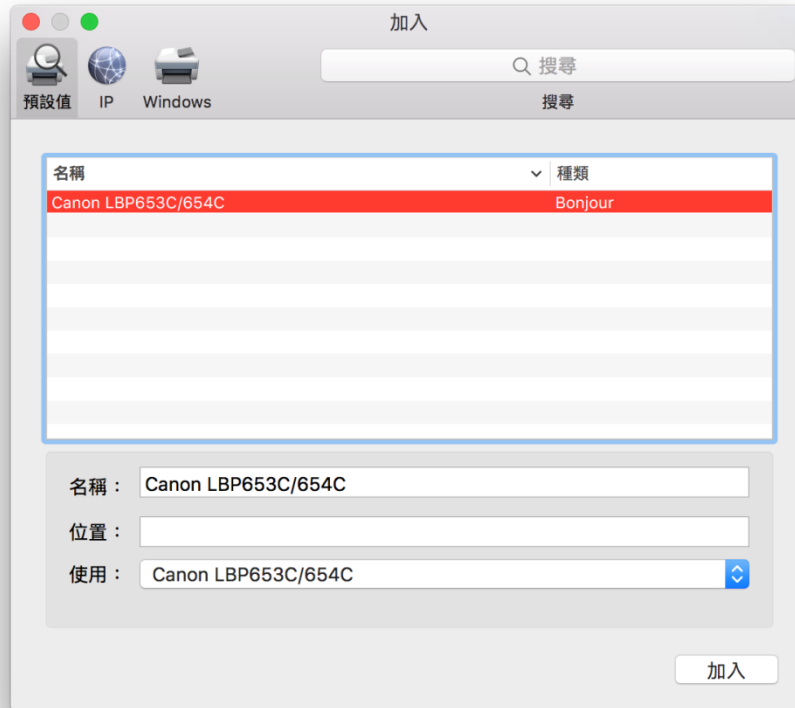

19. 完成以上設定後已可使用印表機作打印功能
Setup completed. Print functions are ready to use

-完-
-End-