

## MG3070 / MG3077 - 無線設定 (流動裝置)

### MG3070/ MG3077 - WiFi Setup (Mobile Device)

以下步驟及畫面僅供參考，實際操作畫面可能因裝置型號、系統或軟件版本而有所不同。

The following steps and screens are for reference only, and the actual operation screens may vary depending on the device model, system, or software version.

於流動裝置下載及安裝Canon PRINT

Install Canon PRINT on the mobile device

Android: <https://play.google.com/store/apps/details?id=jp.co.canon.bsd.ad.pixmapprint>

iOS: <https://apps.apple.com/hk/app/canon-print/id664425773>

1. 開啟印表機電源，並確認電源指示燈亮起  
Turn on the printer, and confirm the power indicator is lit

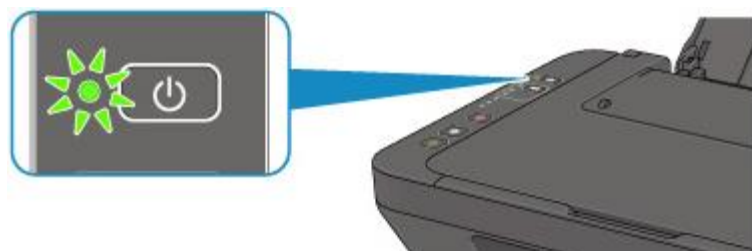

2. 啟動印表機的無線設定模式。按住印表機上的無線按鈕直至無線指示燈閃爍  
Activate the printer Wi-Fi setup mode. Press and hold the Wireless button on the printer until the Wireless lamp is flashing

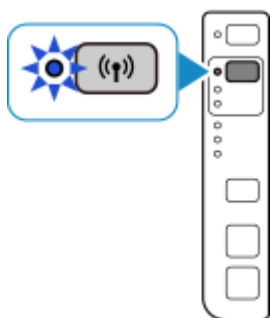

3. 接著按一次彩色按鈕  
Then press the Color button

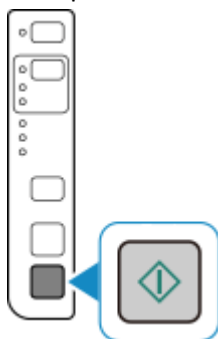

4. 重複按無線按鈕直至網路指示燈亮起

Press the Wireless button repeatedly until the Network lamp lights up

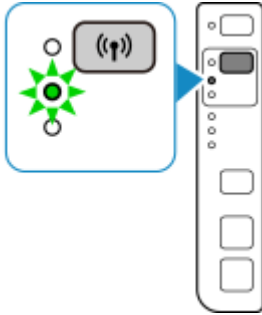

5. 按彩色按鈕

Press the Color button

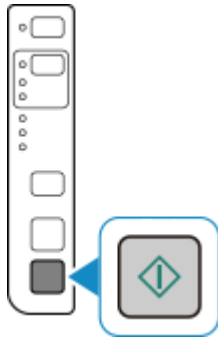

6. 確保無線指示燈閃爍

Make sure the Wireless lamp is flashing

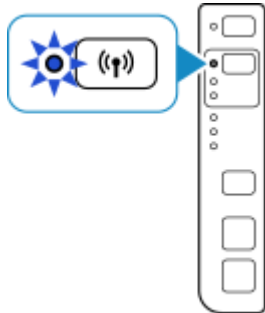

7. 從裝置上的 Wi-Fi 設定中選擇印表機的網路名稱(以「Canon\_ij\_」開頭的 SSID)

Select the printer's network name start with (Canon\_ij\_) from the Wi-Fi settings on your smart device

8. 執行 Canon PRINT

Run the Canon PRINT



**Canon**

9. (可選) 勾選同意資料傳送設定，然後按“確定”  
(Optional) Check the boxes and agree the settings for Data Sending, and then tap “OK”

使用前

您可以設定有關此應用程式和已連接印表機的資訊傳送設定。如果您不同意傳送使用服務所需的資訊，則您將無法使用基於傳送此類資訊所提供的服務。Canon 將根據我們的隱私權原則 (請參閱以下連結) 使用您的資訊。您可以隨時變更資料傳送設定。  
[隱私權原則](#)

[可選] Canon 將收集並使用與使用此應用程式以及已連接印表機相關的服務所需的資訊 (請參閱以下連結獲取詳細資訊)。  
[詳細資訊](#)

☒ 同意

[可選] Canon 將收集並使用有關您在此應用程式和已連接印表機上的活動資訊，以開發我們的產品和服務並提高品質等 (請參閱以下連結獲取詳細資訊)。  
[詳細資訊](#)

☒ 同意

[可選] 我訂閱接收來自 Canon 的限時搶購和特別優惠等訊息。

☒ 同意

☒ 全部勾選

確定

Before Use

You can set up the settings for sending information about this application and the connected printers. If you do not agree to send the information that is necessary to use the services, you are not able to use the services provided on the basis of your sending such information. Canon uses your information according to our Privacy Policy (please see the link below). You can change your settings for data sending at any time.  
[Privacy Policy](#)

[Optional] Canon collects and uses the information that is necessary to use this application and the services related to the connected printers (please see the link below for details).  
[Details](#)

☒ Agree

[Optional] Canon collects and uses the information about your activities on this application and the connected printers, to develop our products and services and improve their quality etc. (please see the link below for details).  
[Details](#)

☒ Agree

[Optional] I subscribe to receive messages about flash deals and special offers etc. from Canon.

☒ Agree

☒ Check all

OK

10. 按“允許”同意追蹤  
Tap “Allow” to accept tracking

允許「PRINT」追蹤  
你在其他公司的 App  
和網站上的活動嗎？

Canon 將使用您的資料，以使產品與服務的開發和銷售更好地滿足用戶的需求，並分析廣告效果。

要求 App 不要追蹤

允許

Allow “PRINT” to track your  
activity across other  
companies’ apps and  
websites?

Canon will use your data to develop  
and market products and services that  
better meet customer needs, and to  
analyze advertising effect.

Ask App Not to Track

Allow

11. 允許尋找網絡上的裝置，按“允許”  
Allow to search the devices on the local network, tap “Allow”

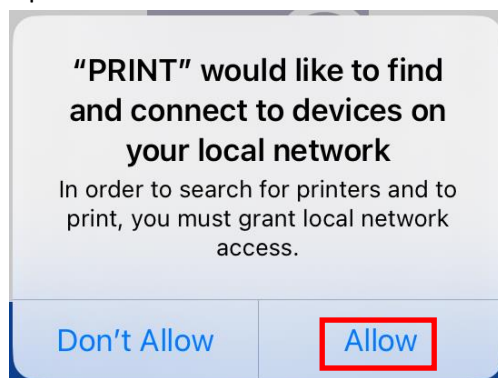

12. 搜尋可用的印表機，按“搜尋”  
Search for available printer, tap “Search”

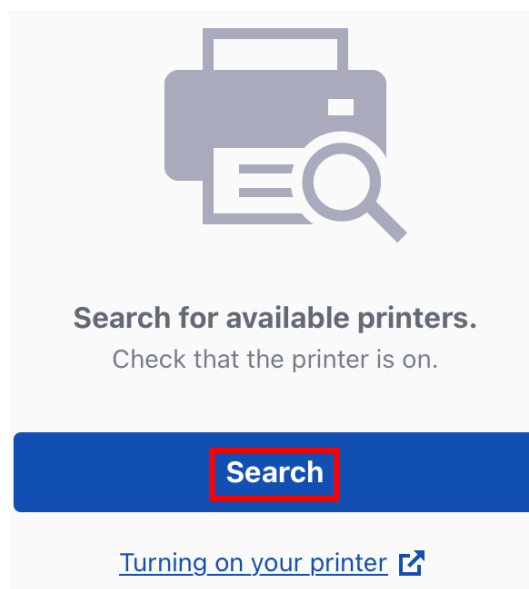

13. 處理中，請稍候  
Processing, please wait

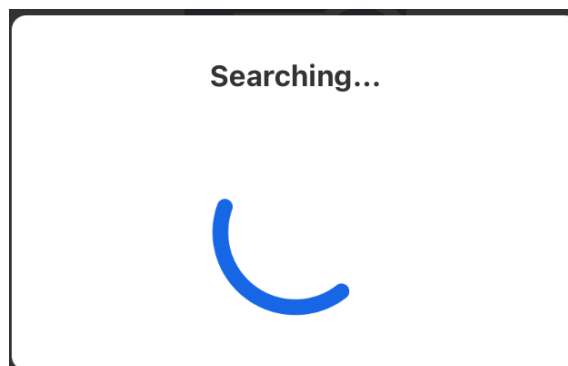

14. 請確保印表機與**流動裝置**連到相同無線網路，按“確定”  
Be sure the printer and mobile device connect to the same network, tap “OK”

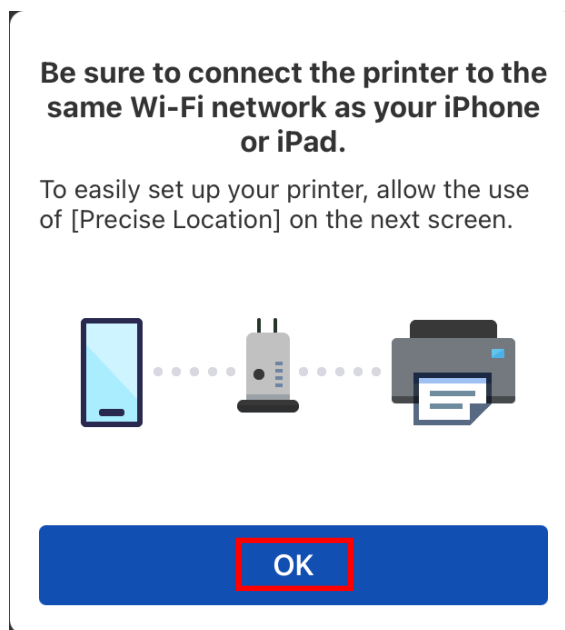

15. 允許使用位置，按“使用 App 時允許”  
Allow to use the location, tap “Allow While Using App”

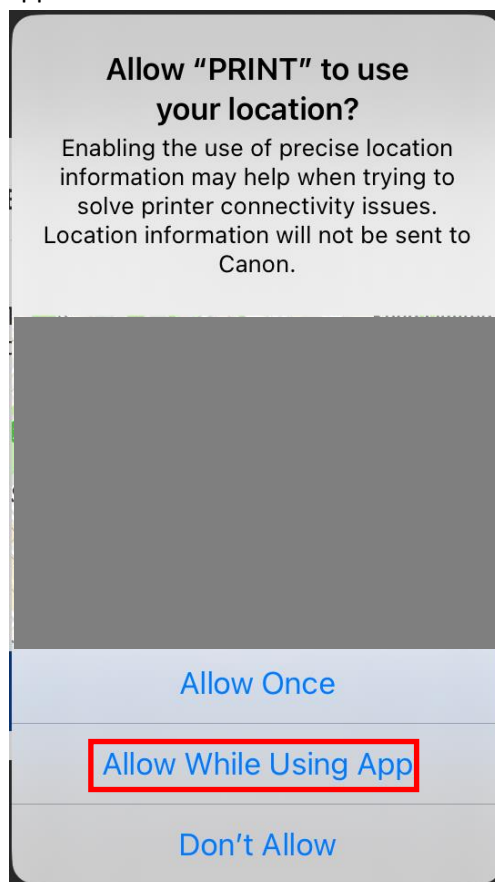

16. 請在以下對話方塊上選擇〔加入〕，按“確定”  
Select [Join] on the following dialog, tap “OK”

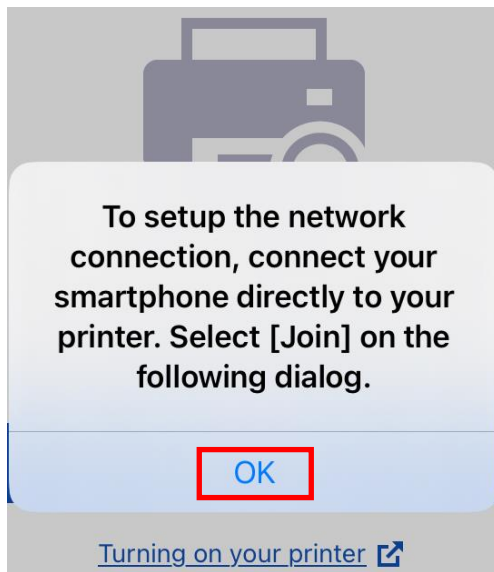

17. 非鐳射打印機系列，按“否”繼續  
Tap “No” to continue for non-laser printer series

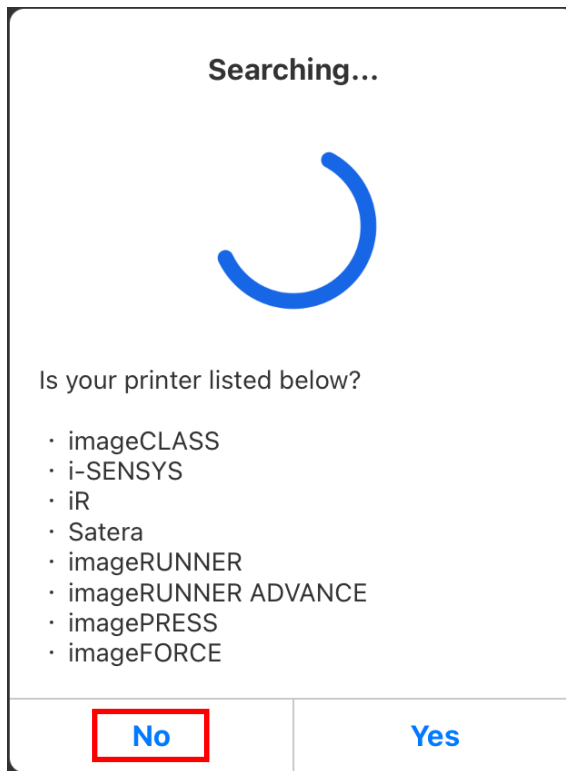

18. 如顯示加入〔Canon\_ij\_〕開頭的網路名稱，按“加入”  
Tap “Join” to join the network name start with “Canon\_ij\_”

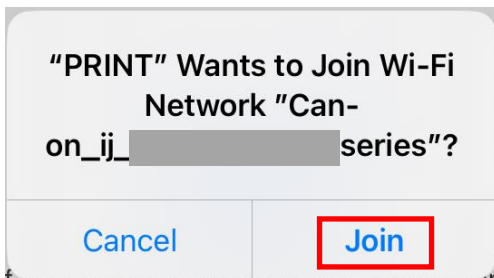
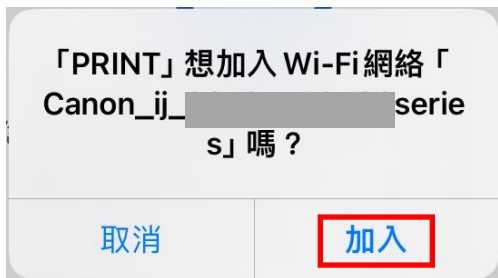

19. 請等候搜尋印表機  
Please wait for searching printer

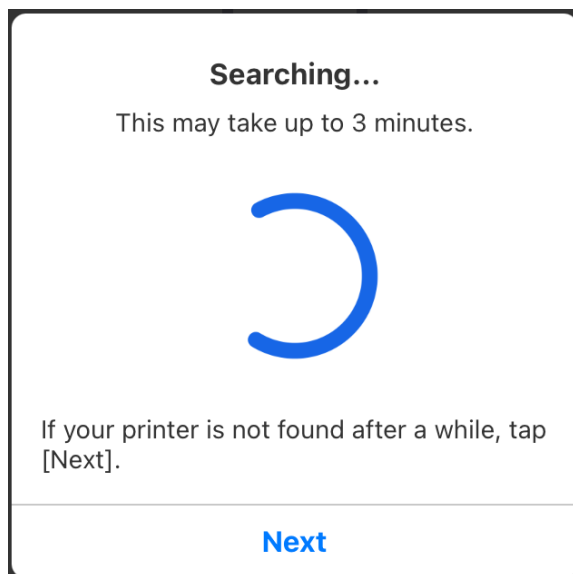

20. 從清單中點選要連接印表機的無線路由器網路名稱  
Tap the wireless router SSID which the printer will be connected from the list

選擇無線路由器

從以下清單中選擇您的無線路由器。如果您的路由器未列出，請點選 [直接連接]。

直接連接

Select Wireless Router

Select your wireless router from the following list. If your router is not listed, tap [Direct Connection].

Direct Connection

21. 輸入無線路由器密碼，然後按“確定”  
Enter the password for wireless router, then tap “OK”

請輸入所選無線路由器的密碼。

☐ 顯示密碼

如果忘記密碼

檢查 Wi-Fi 設定

嘗試其他連線方法

取消 確定

Enter the password for the selected wireless router.

☐ Show password

If you forgot your password

Check Wi-Fi Settings

Try Other Connection Mthd.

Cancel OK

22. 正在與印表機通訊，請稍候  
Communicating with the printer, please wait



23. 連接成功後按 “X” 關閉提示畫面  
After successful connection tap “X” to close the prompt

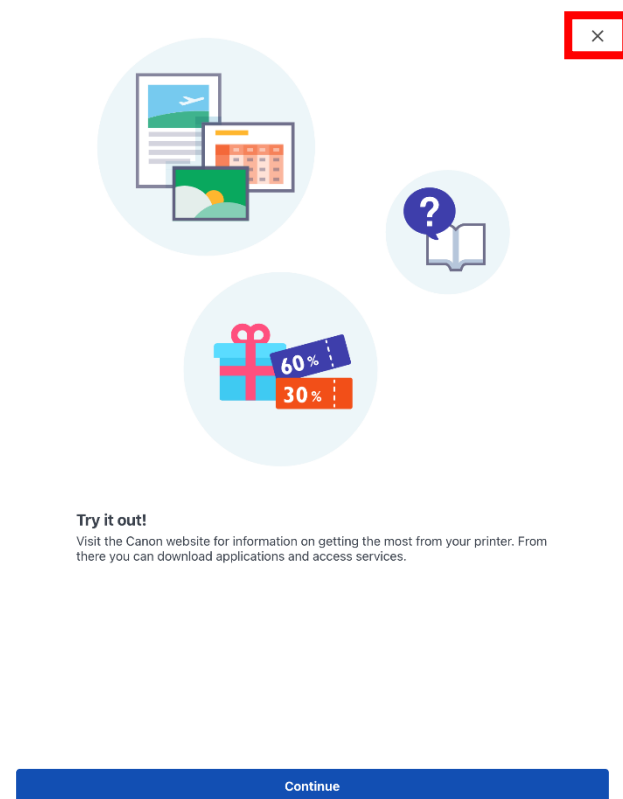

24. 選擇影像嘗試列印或按 “X” 關閉

Choose the photo and try to print, or tap “X” to close



現在選擇您喜愛的相片並嘗試列印吧！

Now choose your favorite photo and try it out!

選擇影像

Select Images

25. 按“確定”並完成無線設定  
Tap “OK” and complete the wireless setup

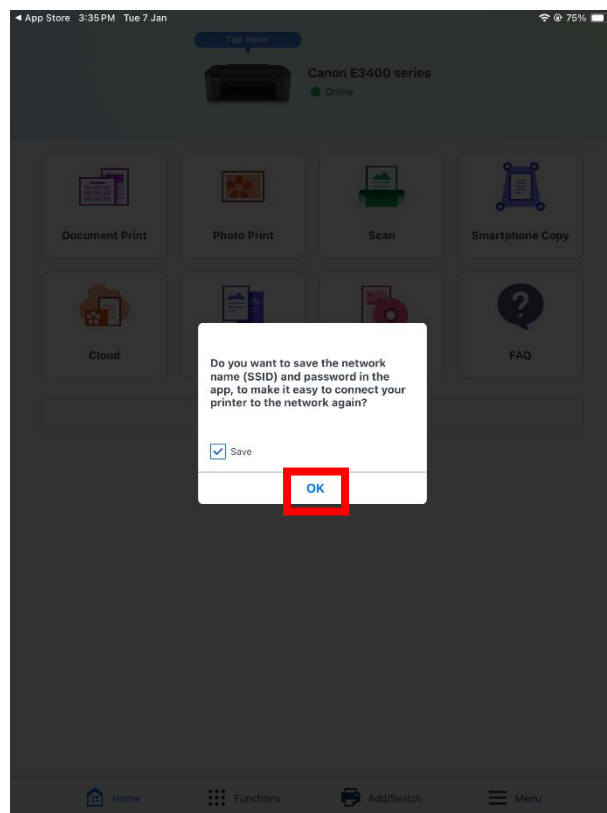
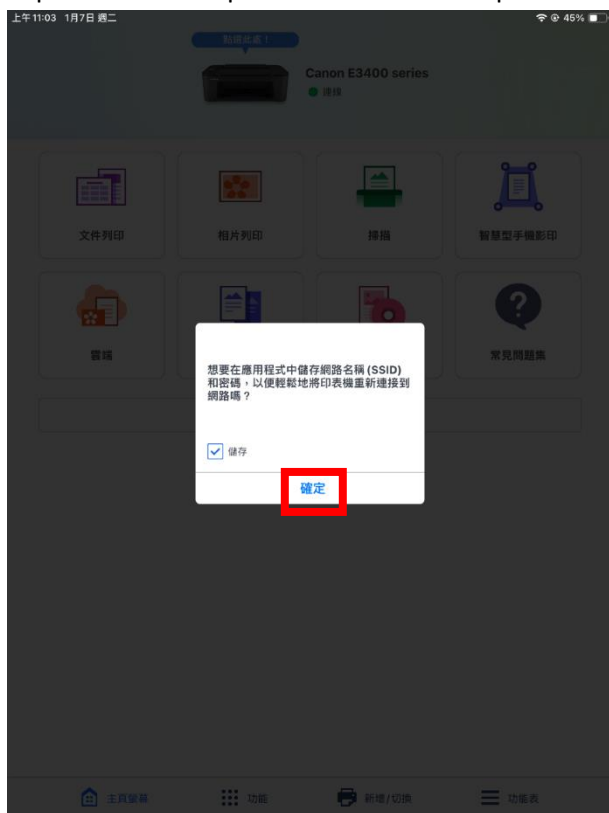

-完-  
-End-