

在 MAC OS X 透過無線 LAN 連線連接 MG3070 / MG3077 之驅動程式步驟 (以 OS X 10.11 作示範)
MG3070/MG3077 printer driver Installation Guide for MAC OS X via Wi-Fi (OSX 10.11 as example)

點擊以下連結下載有關之驅動程式：

<http://ugp01.c-ij.com/ij/webmanual/WebPortal/PTL/ptl-setup.html?lang=tc&type=setup&area=hk&model=MG30&os=m>

Click below link to download printer driver:

<http://ugp01.c-ij.com/ij/webmanual/WebPortal/PTL/ptl-setup.html?lang=en&type=setup&area=hk&model=MG30&os=m>

下載及安裝步驟

Download and installation

1. 按一下「下載」。下載完成後開啟該檔案安裝，點擊「Setup」
Click “Download”. Open the file after download is completed, and then click “Setup”



2. 確保電腦能連接互聯網後按「打開」
Ensure computer can access Internet, and then click “Open”



- 按「下一步」
Click “Next”

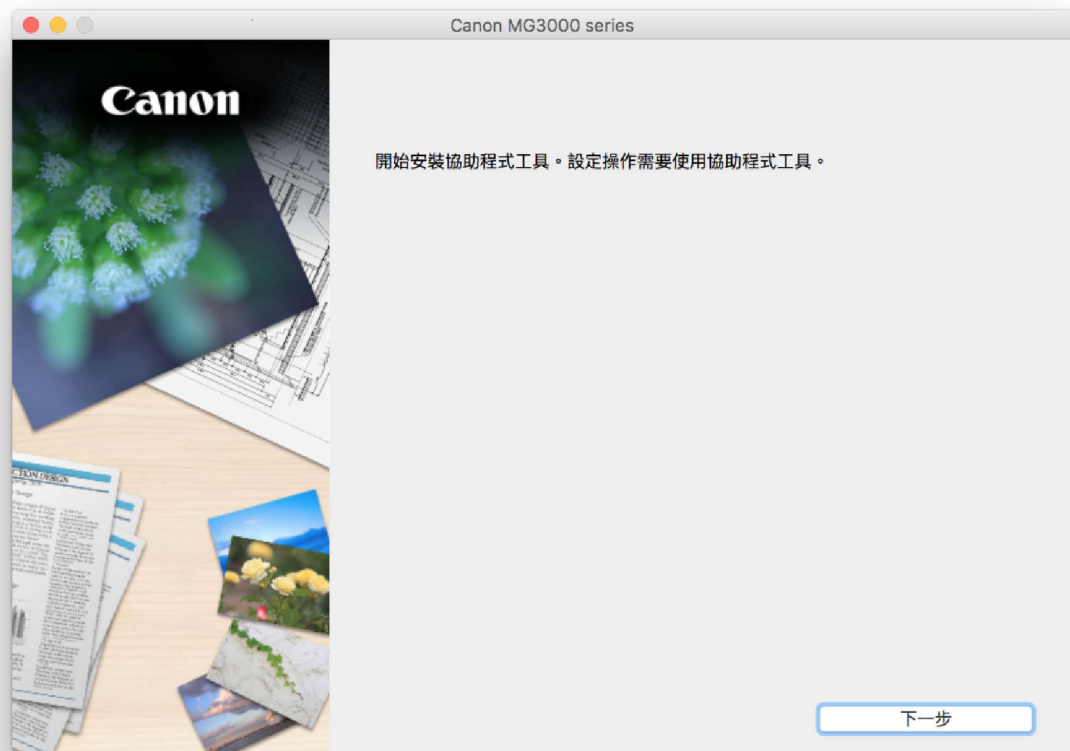

- 輸入登入名稱及密碼（如出現以下畫面），然後按「安裝輔助程式」
Enter the login username and password (If this screen is shown below), and then click “Install Software”

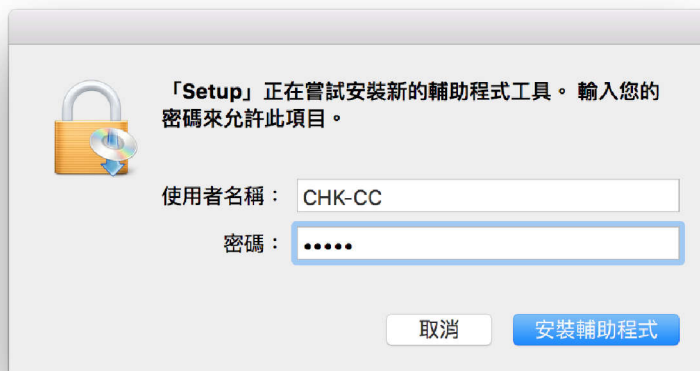

- 按「開始設定」
Click “Start setup”

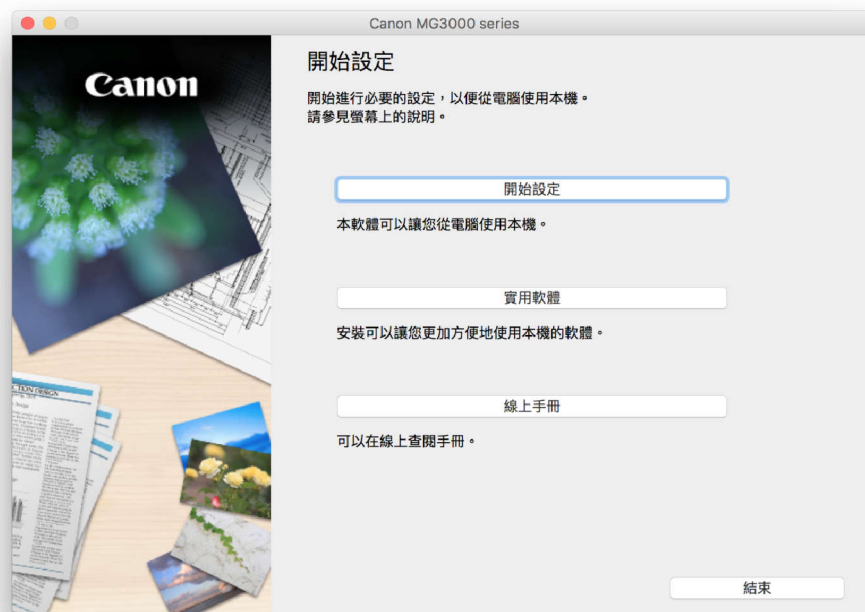

- 選擇「亞洲」>「中國香港特別行政區」，按「下一步」
Select “Asia” > “Hong Kong SAR China”, and then click “Next”

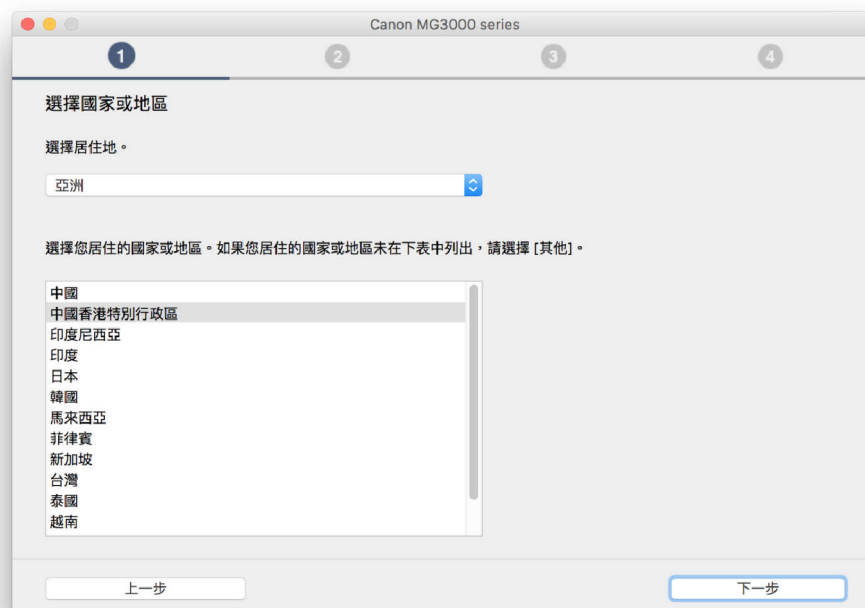

- 選擇「無線 LAN 連接」，然後按「下一步」
Select “Wireless LAN Connection”, and then click “Next”



- 確定印表機已開啟，然後按「下一步」
Make sure printer is on, and then click “Next”

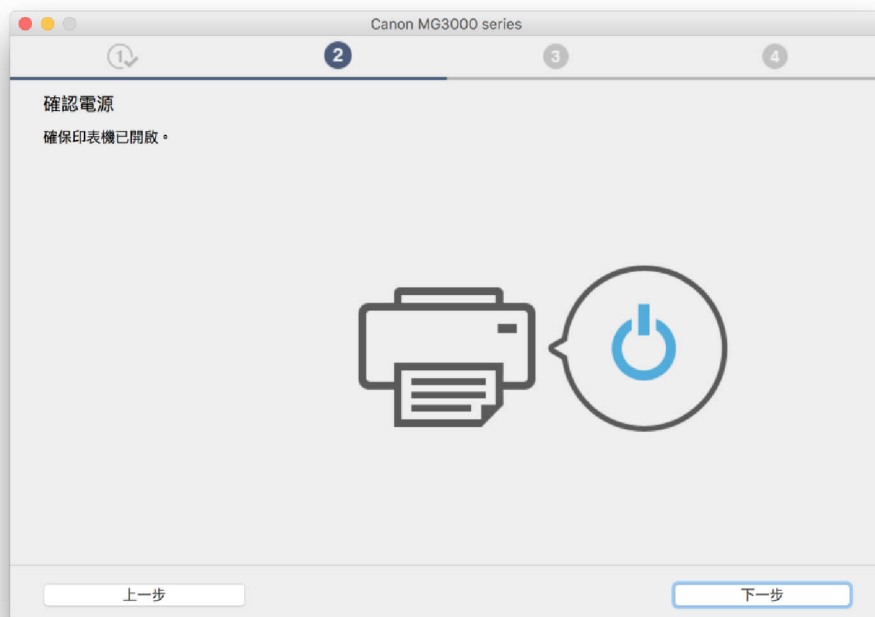

11. 如清單上有印表機，點選印表機後按「下一步」，然後跳至[步驟 28](#)。如清單上沒有印表機，則繼續下一步驟
If printer is on the list, select the printer, click “Next”, and then jump to [step 28](#). Otherwise, go to next step

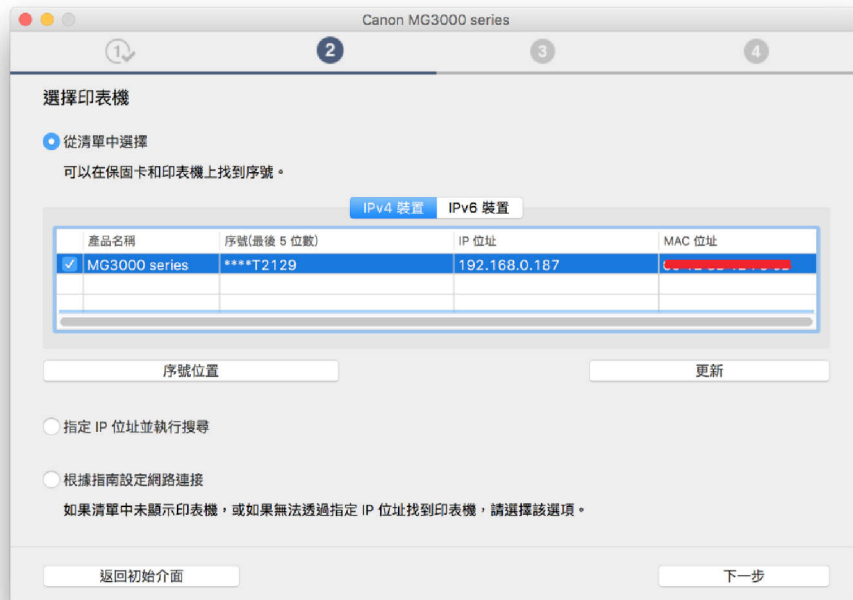

12. 如清單上沒有印表機，點選「根據指南設定網路連接」，然後按「下一步」
If there is no printer on the list, select “Set up the network connection according to the guide”, and then click “Next”

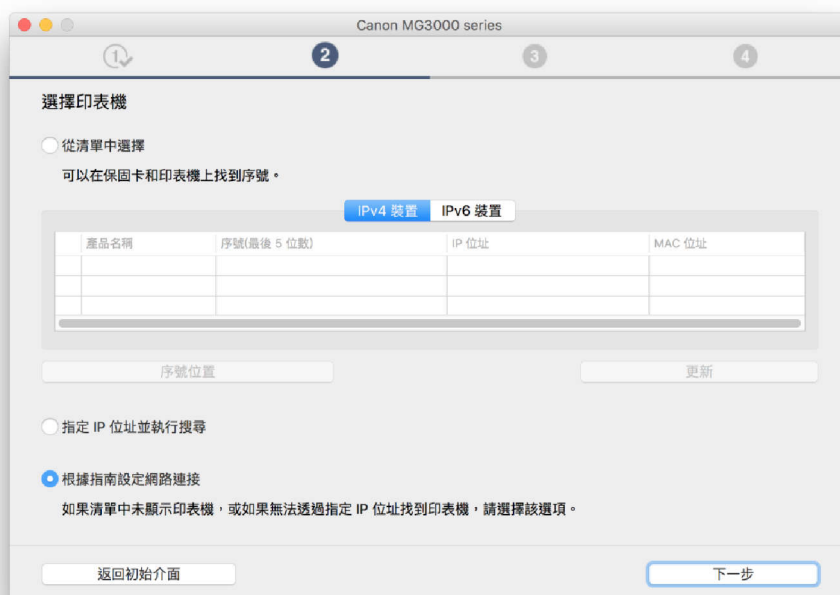

13. 如印表機上 Wi-Fi 指示燈閃爍，按印表機上停止 (Stop) 按鈕一下，然後按「下一步」
If the Wi-Fi lamp on the printer is flashing, press the "Stop" button one time. Click "Next"

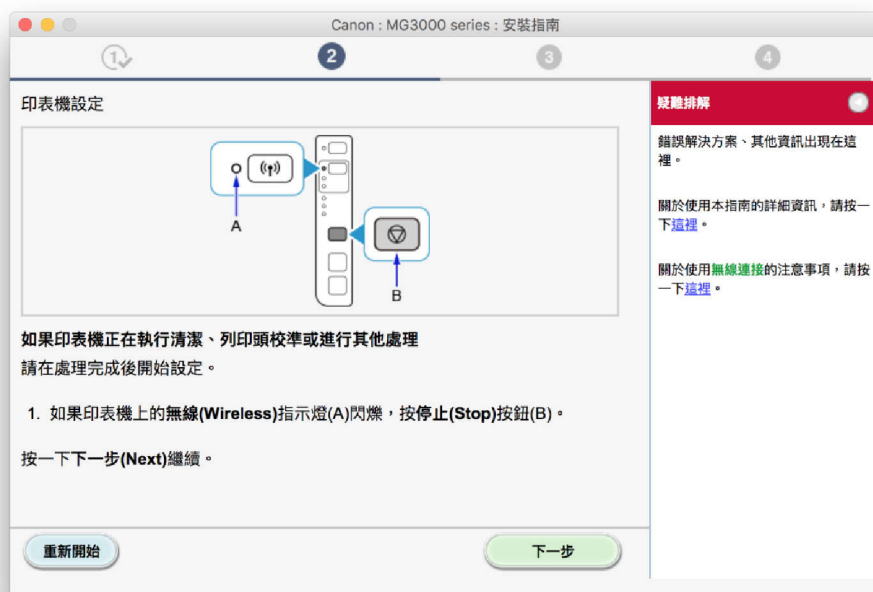

14. 根據以下畫面指示控制，然後按「下一步」(如電腦不支援無線連線，不需按控制，直接按「下一步」，跳到下一步驟)
Follow the instruction below to press the buttons on printer, and then click "Next" (If computer does not support Wi-Fi, click "Next" without pressing the button, jump to next step.)



15. 確保無線指示燈閃爍，然後按「下一步」（如電腦不支援無線連線，直接按「下一步」，然後前往下一步驟）

Make sure the “Wireless” lamp is flashing, and then click “Next” (If computer does not support Wi-Fi, click “Next” to go to next step.)



16. 等待完成印表機網路設定

Wait for the completion of printer wireless setup

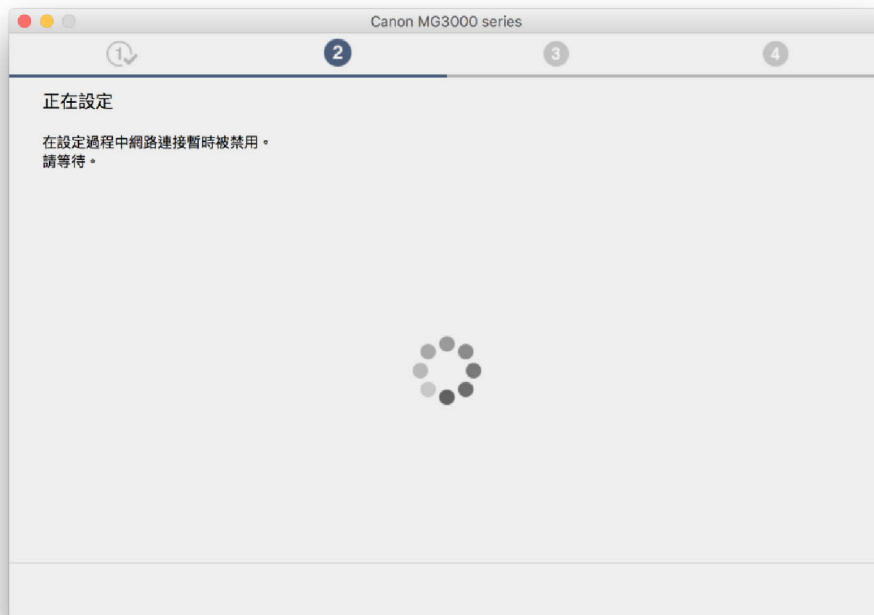

17. 如出現以下畫面，連接已完成，按「下一步」，跳至步驟 28。否則繼續下一步驟
If the screen below appears, connection is completed. Click “Next”, and then jump to [step 28](#).
Otherwise go to next step

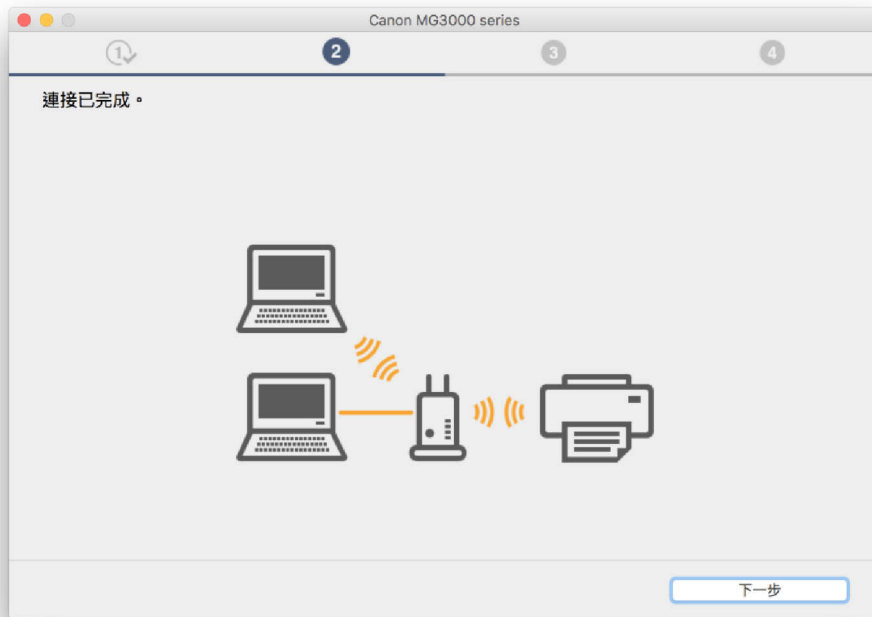

18. 如電腦不支援無線網路連線或連線失敗會出現以下畫面，按「下一步」
If computer does not support Wi-Fi network connection or the connection is failed, click “Next”



19. 如印表機上 Wi-Fi 指示燈閃爍，按印表機上停止（Stop）按鈕一下，然後按「下一步」
If the Wi-Fi lamp on the printer is flashing, press the “Stop” button one time. Click “Next”

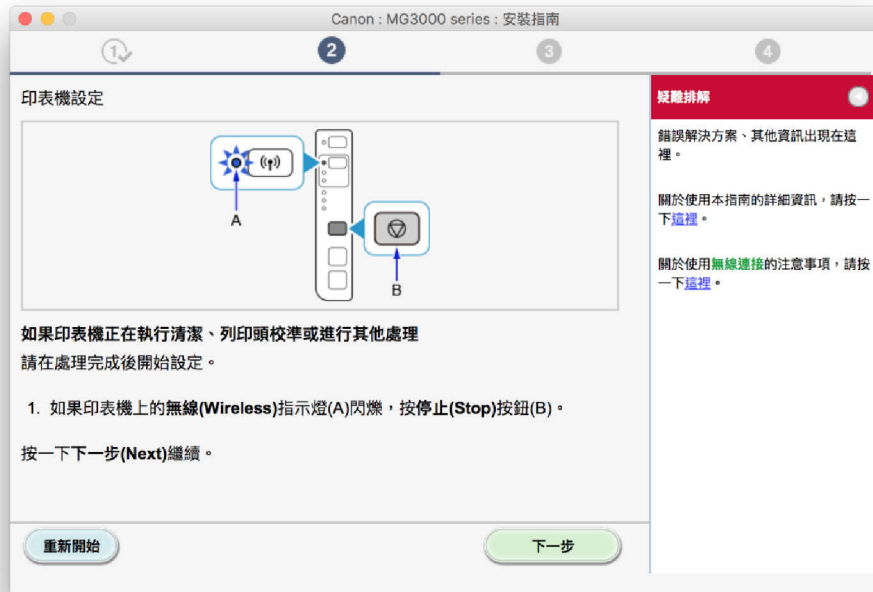

20. 按「使用 USB 電纜線的無線設定」
Click “Wireless Setup Using the USB Cable”



21. 以 USB 電纜線連接印表機和電腦，等待自動偵測印表機
Connect the printer and the computer with the USB cable, wait until printer is detected



22. 如出現以下畫面，按「允許」。否則跳到[步驟 25](#)
If the screen below appears, click "Yes". Otherwise jump to [step 25](#)

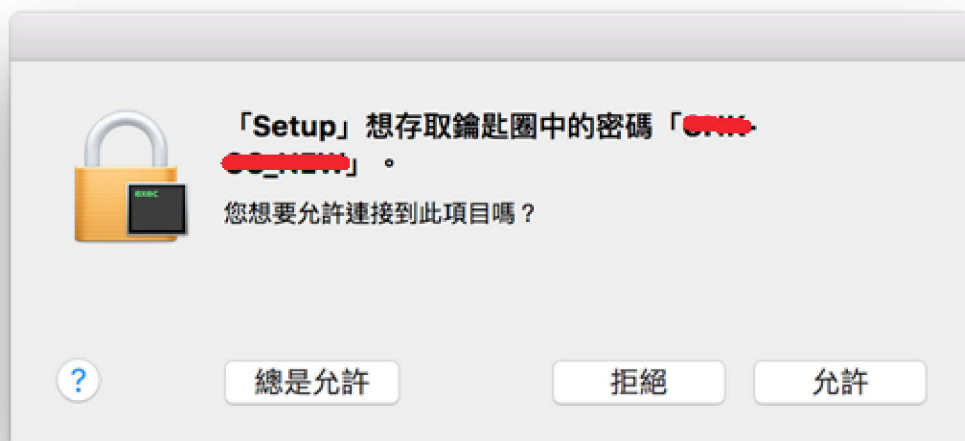

23. 連接已完成，按「下一步」
Connection is completed. Click “Next”

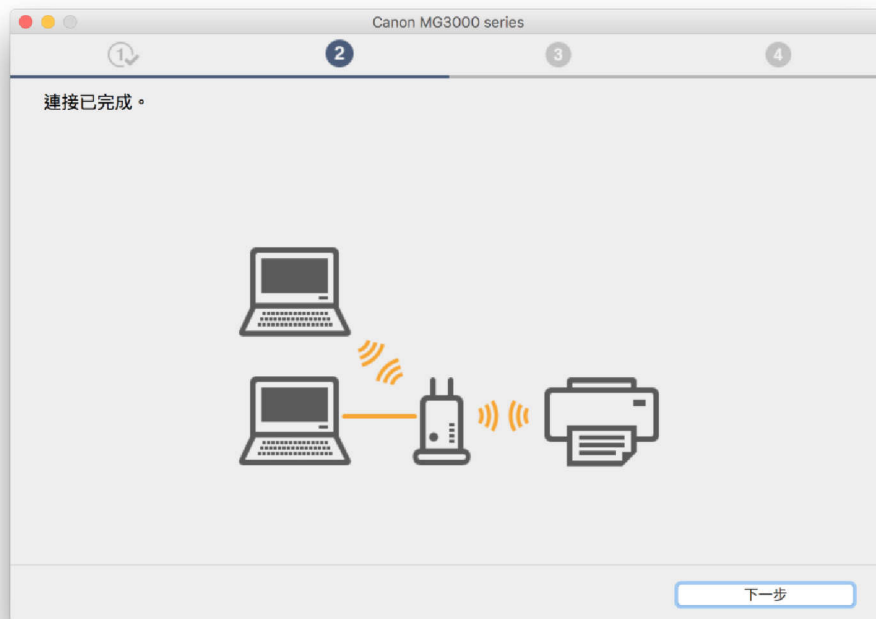

24. 完成設定後斷開 USB 連接線，按「下一步」，然後跳至[步驟 28](#)
Disconnect USB cable after setup is completed, click “Next”, and then jump to [step 28](#)



25. 選擇要連接到的無線路由器，輸入密碼（網路金鑰）後按「下一步」
Select access point and input password (Network Key), and then click “Next”

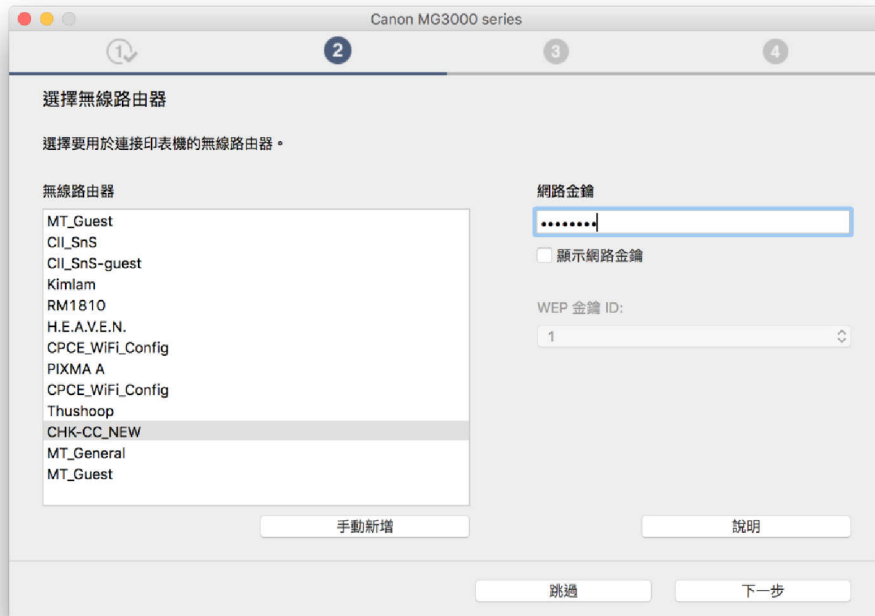

26. 連接已完成。按「下一步」
Connection is completed. Click “Next”



27. 完成設定後斷開 USB 連線，然後按「下一步」
Disconnect USB cable after setup is completed. Click "Next"



28. 等待軟件安裝
Wait for the installation progress



29. 按「新增印表機」
Click “Add Printer”



30. 在新增印表機視窗，選擇印表機「Canon MG3000 series」，確定「使用」是「Canon MG3000 series」
Choose name as “Canon MG3000 series”, and make sure “Canon MG3000 series” is in “Use” column



31. 再次回到此畫面，按「下一步」
Return to this screen again. Click “Next”



32. 建議按「執行」執行列印頭校準。然後按「下一步」
Suggest to click “Execute” to perform print head alignment. Click “Next”



33. 安裝完成後建議可按「執行」列印測試頁。然後按「下一步」
After installation is completed, we suggest to click “Execute” for print test page. Click “Next”



34. 驅動程式安裝完成，安裝軟件請按「下一步」
Driver installation is completed. Click “Next” to install software

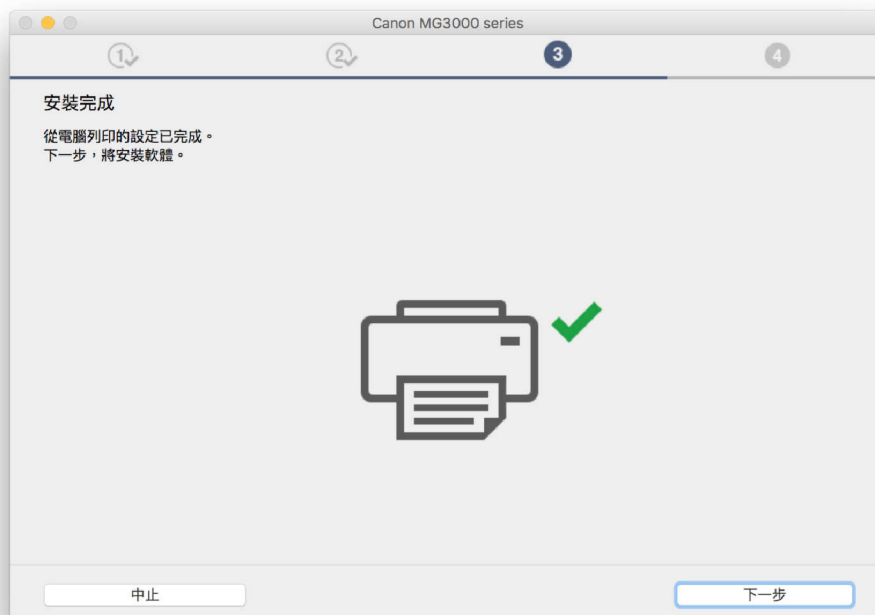

35. 在軟體安裝清單勾選所需軟件，按「下一步」
Select needed software, and then click “Next”

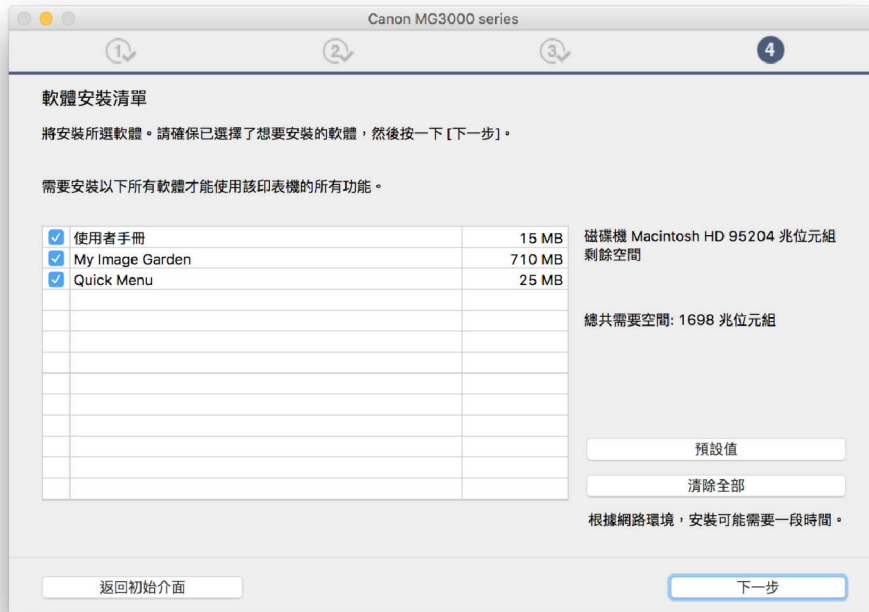

36. 選擇是否同意建立使用者手冊的捷徑，然後按「下一步」
Select “Agree” or “Disagree” to create a user manual shortcut, and then click “Next”

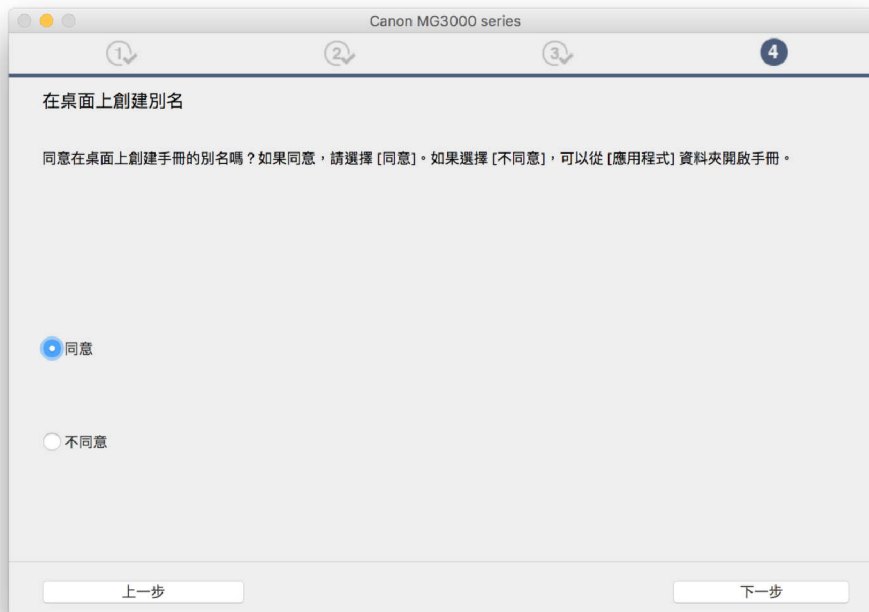

37. 等待軟件安裝

Wait for the installation progress



38. 按「結束」完成安裝

Click "Finish" to complete the installation

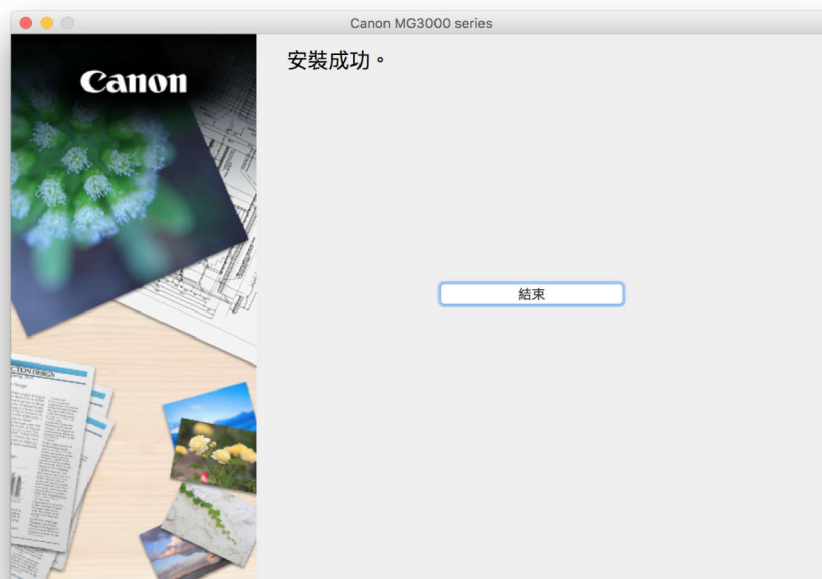

-完-
-End-