

在MAC OS X以無線網路接駁安裝PRO-500驅動程式步驟 (以OSX 10.11作示範)
PRO-500 printer driver Installation Guide for MAC OS X (Via Wi-Fi) (OSX 10.11 as example)

連接打印機至無線網路路由器
Connect printer to Wi-Fi router

1. 按主頁 (HOME) 按鈕 (A)
Press the HOME button (A)

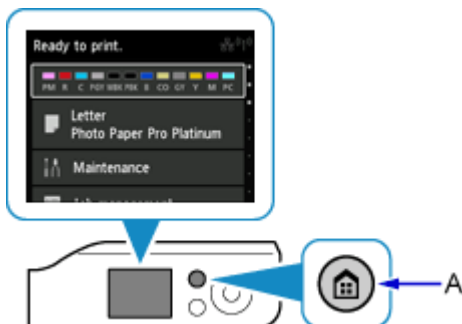

2. 使用▲或▼按鈕(B)選擇LAN設定 (LAN settings) ，然後按OK按鈕
Use the ▲or ▼button (B) to select LAN settings, and then press the OK button

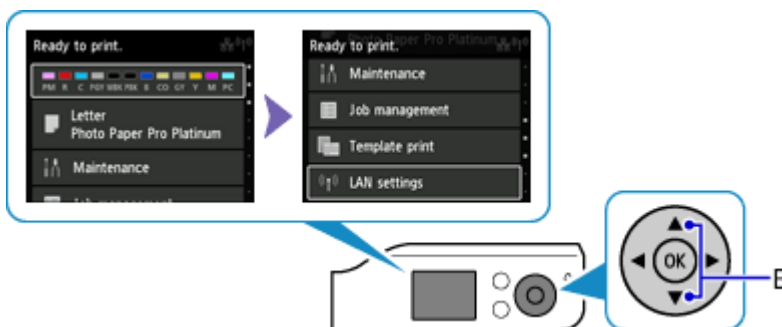

3. 選擇無線LAN設定 (Wireless LAN setup) 並按OK按鈕
Select Wireless LAN setup and press the OK button

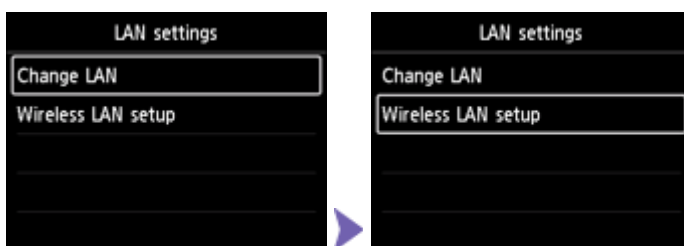

4. 選擇標準設定 (Standard setup) 並按OK按鈕
Select Standard setup and press the OK button

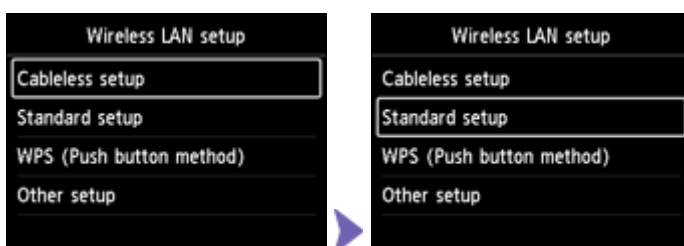

5. 選擇無線路由器並按OK按鈕
Select your wireless router and press the OK button

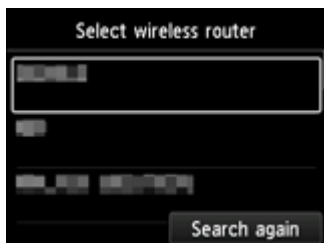

6. 將顯示以下螢幕之一
One of the screens below will appear

如果出現「已連接到無線路由器。(Connected to the wireless router.)」，則網路不需要密碼。請轉到[步驟11](#)並繼續進行設定

If "Connected to the wireless router." appears, the network does not require a password. Go to [step 11](#) and proceed with the setup

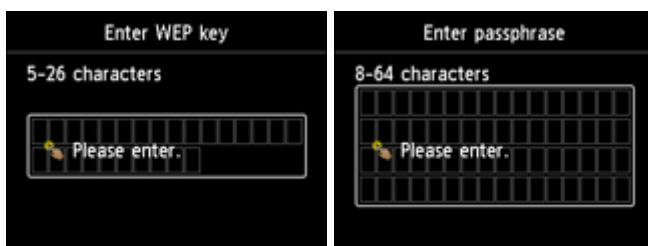

7. 按OK按鈕
Press the OK button
8. 輸入網路密碼
Enter the network password



9. 使用  按鈕選擇OK，然後按OK按鈕

Use the  button to select OK and press the OK button

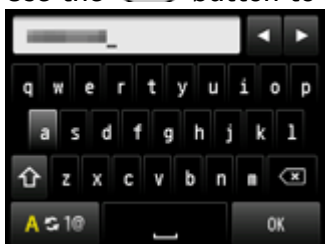

10. 按OK按鈕

Press the OK button



11. 顯示以下螢幕時，請按OK按鈕

When the screen on the below appears, press the OK button

連接完成後，會出現在螢幕右上方

When connection is completed, appears at the upper right of the screen

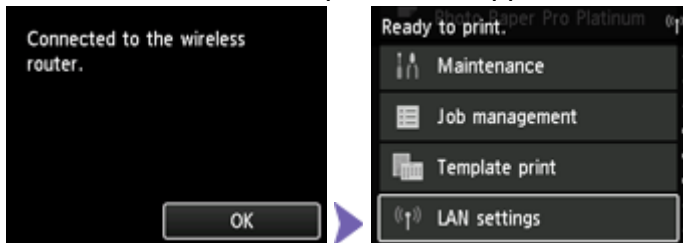

點擊以下連結下載有關之驅動程式：

[http://ugp01.c-ij.com/ij/webmanual/WebPortal/PTL/ptl-setup.html?
lang=tc&type=setup&area=hk&model=pro-500&os=m](http://ugp01.c-ij.com/ij/webmanual/WebPortal/PTL/ptl-setup.html?lang=tc&type=setup&area=hk&model=pro-500&os=m)

Click below link to download printer driver:

[http://ugp01.c-ij.com/ij/webmanual/WebPortal/PTL/ptl-setup.html?
lang=en&type=setup&area=hk&model=pro-500&os=m](http://ugp01.c-ij.com/ij/webmanual/WebPortal/PTL/ptl-setup.html?lang=en&type=setup&area=hk&model=pro-500&os=m)

下載及安裝步驟 Download and installation

1. 按一下「下載」。下載完成後開啟該檔案安裝，點擊「Setup」
Click “Download”. Open the file after download is completed, and then click “Setup”



2. 按「下一步」
Click “Next”

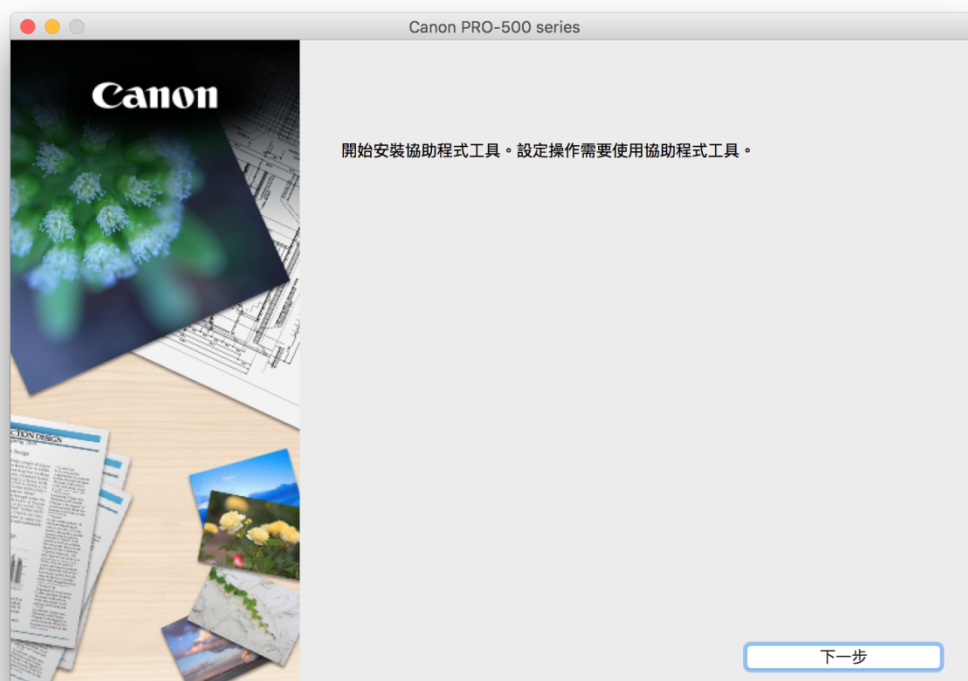

- 按「開始設定」
Click “Start setup”

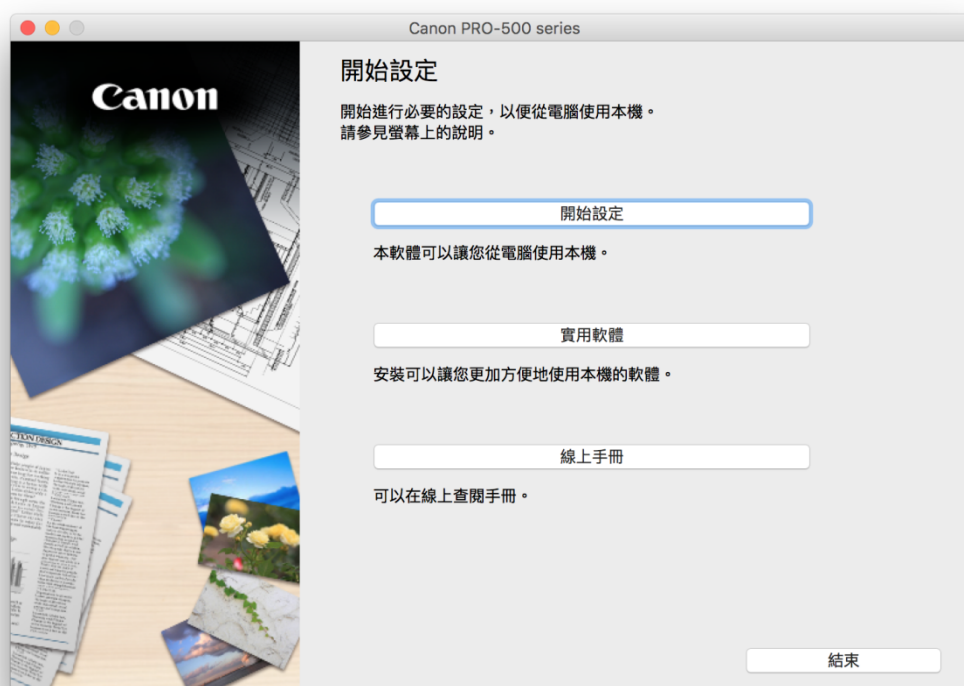

- 選擇「亞洲」>「香港特別行政區」，按「下一步」
Select “Asia”> “Hong Kong SAR China”. Click “Next”



5. 按「是」
Click “Yes”



6. 可選擇是否同意作傳送資訊至Canon
Select “Agree” or “Disagree” to send information to Canon Extended Survey Program



7. 選擇「無線 LAN 連接」，按「下一步」
Select “Wireless LAN Connection”. Click “Next”



8. 按「下一步」
Click “Next”



9. 確定印表機已開啟及連接網路，按「下一步」
Make sure printer is on and connected to network. Click “Next”

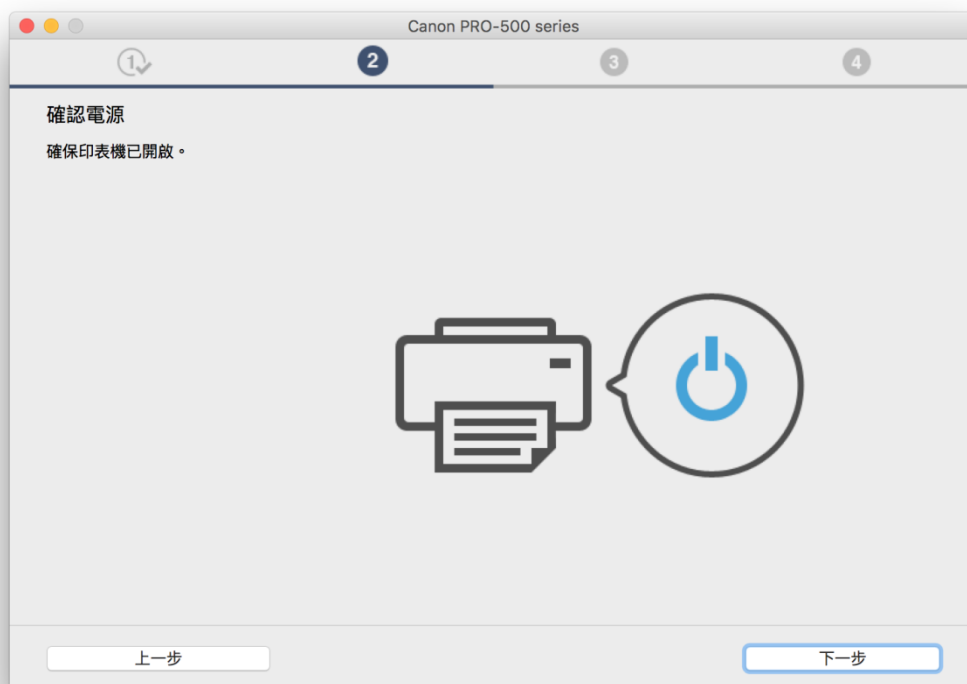

10. 在「網路上印表機的清單」勾選印表機，按「下一步」
Select printer at “Printers on Network List”, and then click “Next”

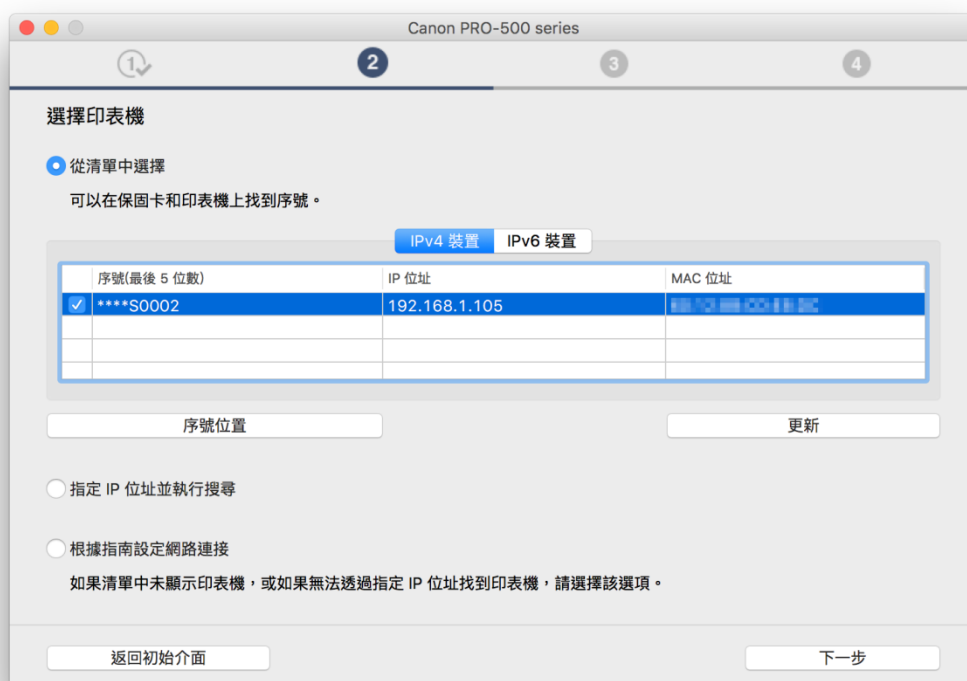

11. 等待軟件安裝 Waiting for the installation progress



12. 按「新增印表機」 Click "Add Printer"



13. 在新增印表機視窗，選擇印表機「Canon PRO-500 series」（種類為Bonjour），確定「使用」為「Canon PRO-500 series」
Choose name as “Canon PRO-500 series” (Kind: Canon IJ Network), and make sure “Canon PRO-500 series” is in “Use” column



14. 再次回到此畫面，按「下一步」
Return to this windows again. Click “Next”



15. 驅動程式安裝完成，安裝軟件請按「下一步」
Driver installation is completed. Click “Next” to install software

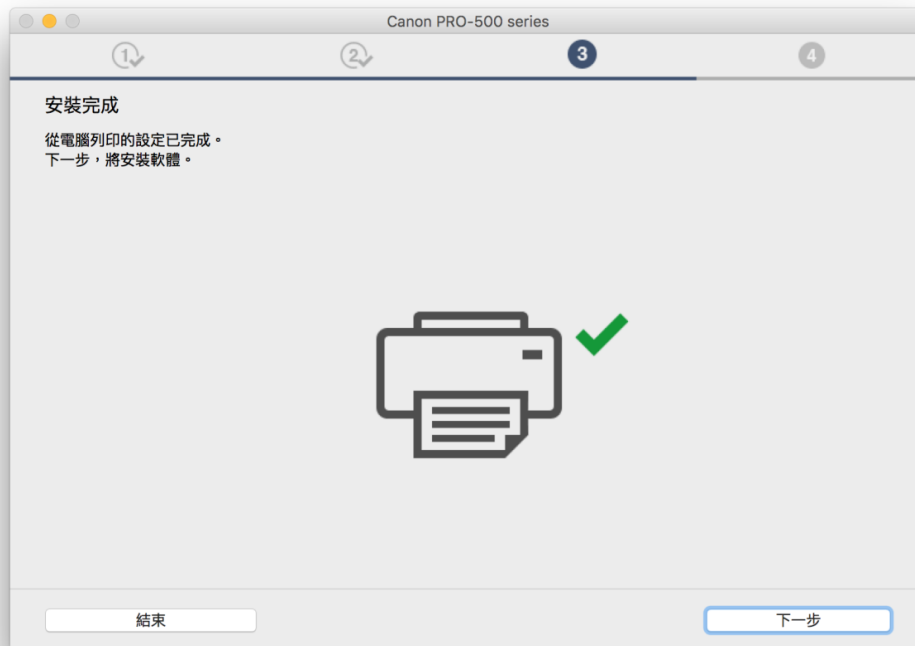

16. 在軟體安裝清單勾選所需軟件，按「下一步」
Select needed software, and then click “Next”

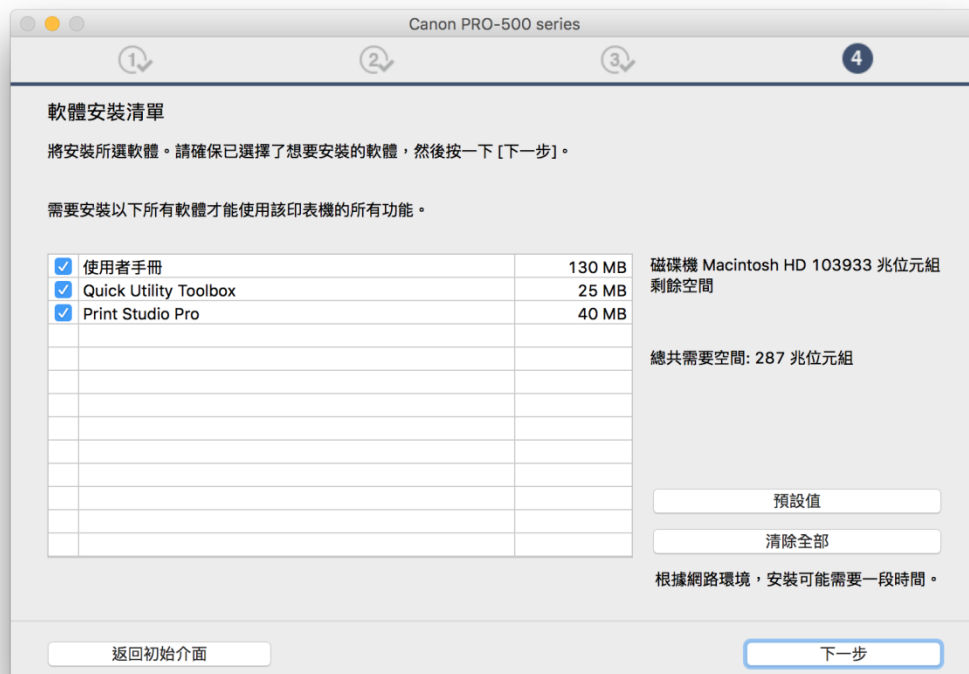

17. 可選擇是否同意建立使用者手冊的捷徑
Select “Agree” or “Disagree” to create a user manual shortcut

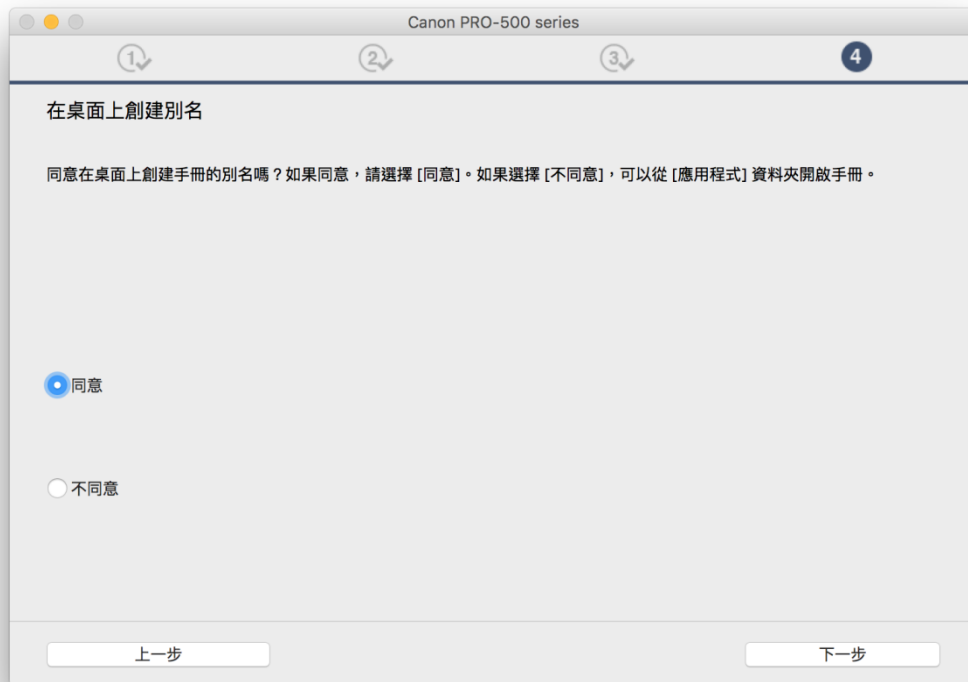

18. 等待軟件安裝
Waiting for the installation progress



19. 按「結束」完成安裝
Click “Finish” to complete the installation



-完-
-End-