

在 MAC OSX 以網路接駁安裝 G3000 驅動程式步驟 (以 OSX 10.11 作示範)
G3000 printer driver Installation Guide for MAC OSX (Via WI-FI) (OSX 10.11 as example)

點擊以下連結下載有關之驅動程式:

<http://ugp01.c-ij.com/ij/webmanual/WebPortal/PTL/ptl-setup.html?lang=tc&type=setup&area=hk&model=g3000&os=m>

Click below link for download printer driver:

<http://ugp01.c-ij.com/ij/webmanual/WebPortal/PTL/ptl-setup.html?lang=en&type=setup&area=hk&model=g3000&os=m>

下載及安裝步驟

1. 按一下「下載」。下載完成後開啟該檔案安裝，點擊「Setup」
Click "Download". Open the file after download completed, click "Setup"

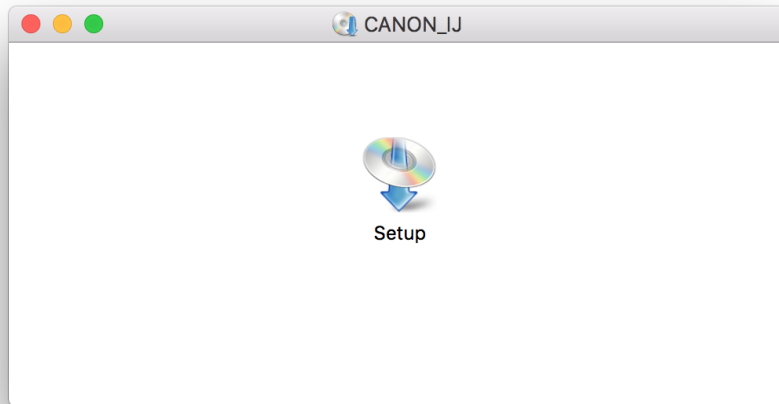

2. 按「下一步」
Click "Next"

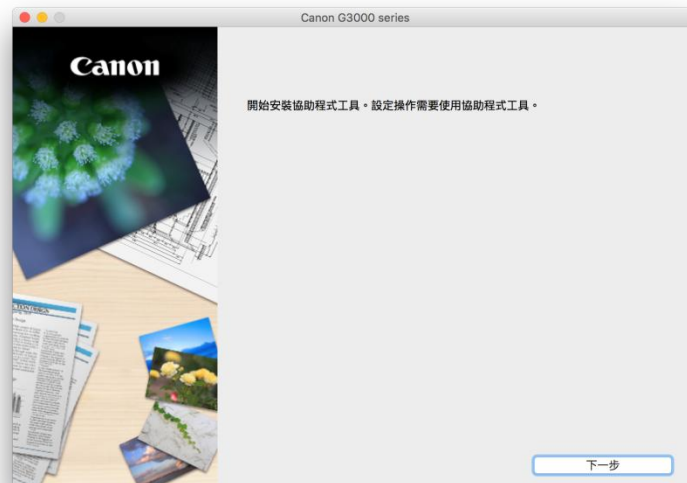

- 按「開始設定」
Click “Start Setup”

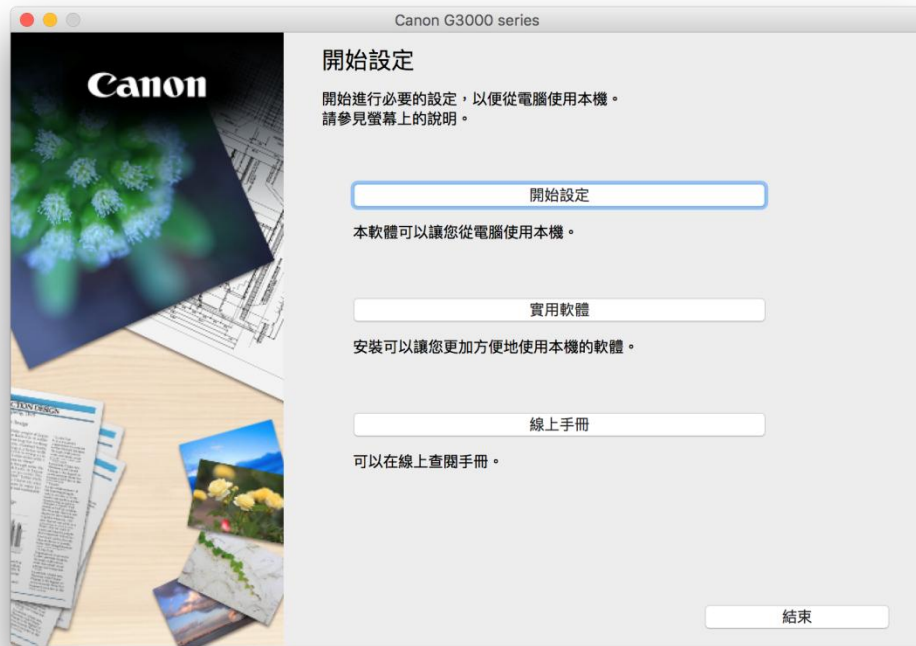

- 選擇「亞洲」、「香港特別行政區」，按「下一步」
Select “Asia”, “Hong Kong SAR China”, click “Next”



5. 按「是」
Click “Yes”



6. 選擇「同意」或「不同意」作傳送資訊至 Canon
Select “Agree” or “Disagree” to send information to Canon Extended Survey Program

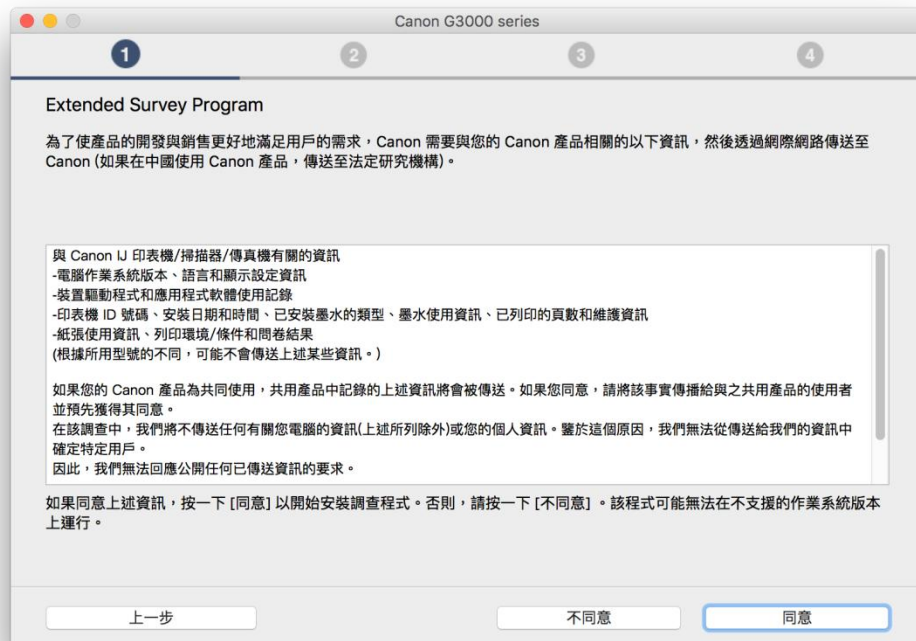

7. 選擇「無線 LAN 連接」，按「下一步」
Select "Wireless LAN Connection", click "Next"



8. 按「下一步」
Click "Next"



9. 確定印表機已開啟及連接網路，在「網路上印表機的清單」勾選印表機，按「下一步」(如清單上沒有印表機，跳至步驟 11) wrong hyperlinks
Make sure printer is on and connected to network, select printer at “Printers on Network List” then click “Next” (If no printer on the list, jump to procedure 11)



10. 等待電腦下載及安裝驅動程式，跳至步驟 26
Wait for download complete and install printer driver. Jump to procedure 26



11. 如清單上沒有印表機，請勾選「在清單中無法找到設定的印表機」，按「下一步」
If there is no printer on the list, click “Setting printer could not be found on the list”. Click “Next”

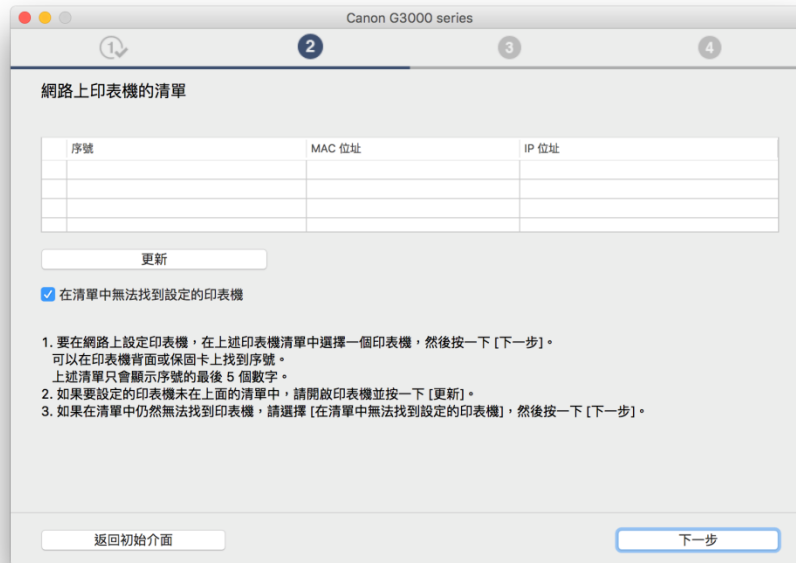

12. 按著印表機上「Wi-Fi」鍵直至電源燈開始閃爍後放手，首先按一下「彩色」按鈕，然後再按一下「Wi-Fi」按鈕，按「下一步」
Hold the “Wi-Fi” button of the printer unit the power indicator lamp starts flashing, then release” Wi-Fi” button. Press “Color” button one time first and then press “Wi-Fi” button one time, click “Next”



13. 根據畫面指示按鍵，按「下一步」(如電腦不支援無線連線，直接按「下一步」跳過此步驟，跳至步驟 17)

Follow instruction and press button on printer then click "Next" (If computer does not support Wi-Fi, click "Next" directly, then jump to [procedure 17](#))

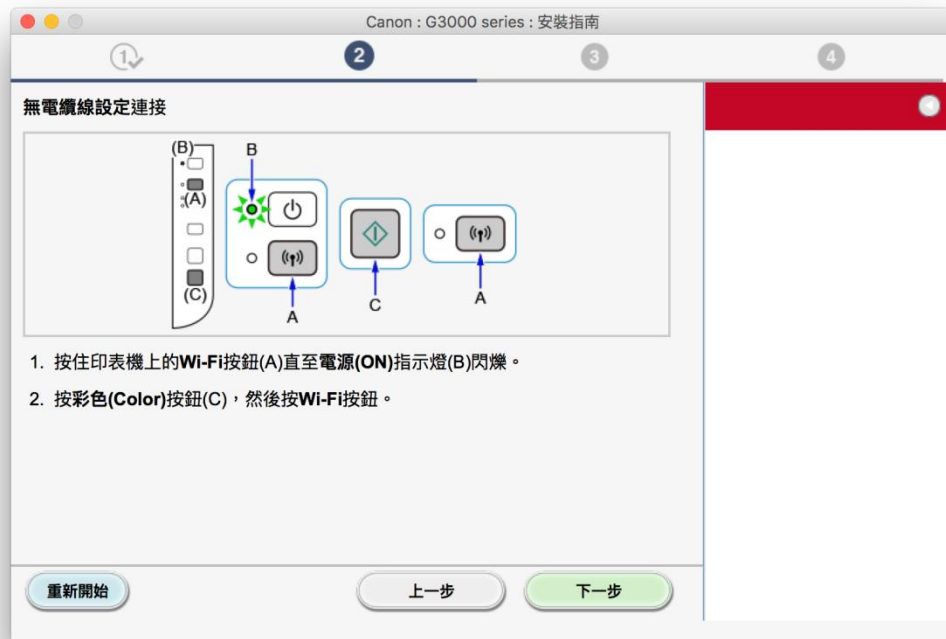

14. 等待完成印表機網路設定

Wait for printer wireless setup complete

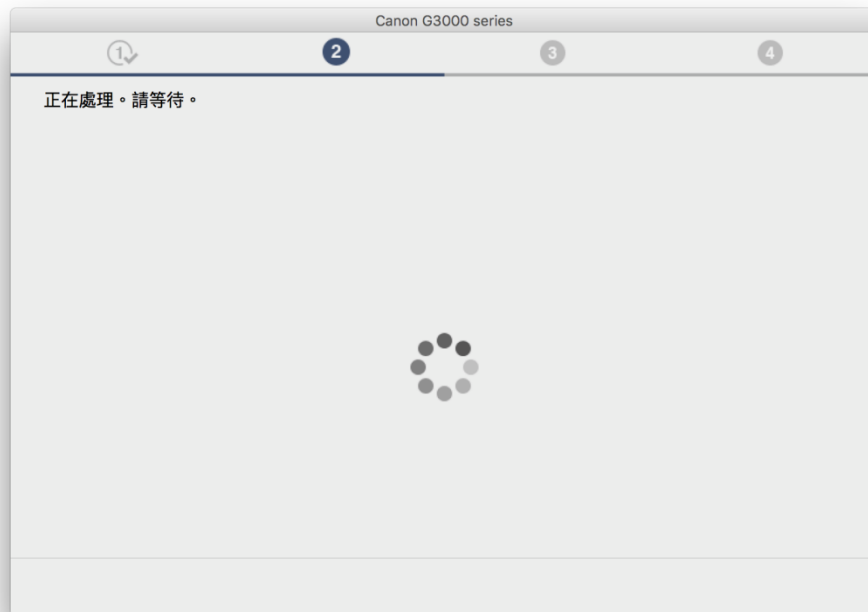

15. 連接已完成，按「下一步」，
Setup complete, click "Next"

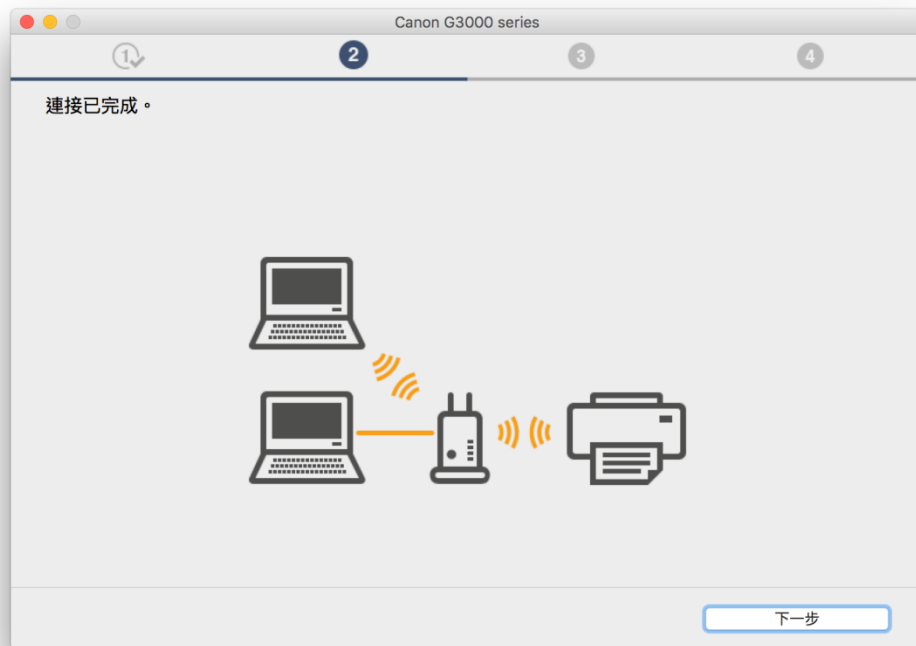

16. 等待電腦下載及安裝驅動程式，跳至步驟 26 wrong link
Wait for download complete and install printer driver, jump to procedure 26



17. 如電腦不支援無線網路連線或連線失敗會出現以下畫面，按「下一步」
If computer does not support Wi-Fi network connection or connection failed, click “Next”



18. 如印表機上 Wi-Fi 指示燈閃爍，按印表機上停止 (Stop) 按鈕
If the Wi-Fi lamp on the printer is flashing, press the “Stop” button



19. 選擇「使用 USB 電纜線的無線設定」
Select “Wireless Setup Using the USB Cable”



20. 等待電腦下載及安裝驅動程式
Wait for download complete and install printer driver



21. 勾選「透過 USB 設定網路連接」，按「下一步」
Tick “Set up the network connection via USB”, click “Next”



22. 以 USB 電纜線連接印表機和電腦，按「下一步」等待自動偵測印表機
Connect the printer and the computer using the USB cable, click “Next” and wait until printer is detected



23. 選擇要連接到的無線路由器，輸入密碼 (網路密碼) 後按「連接」
Select access point and input password (Network Key), then click “connect”

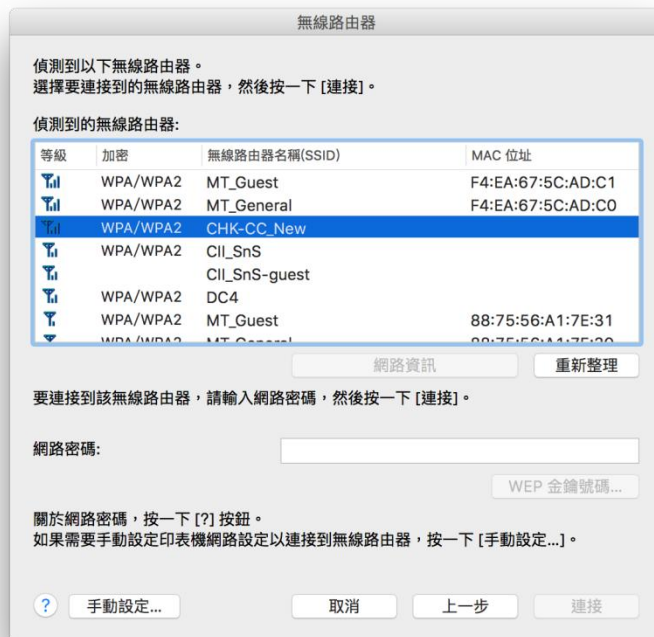

24. 完成設定後斷開 USB 連線，按「下一步」
Disconnect USB cable after installation completed, click “Next”



25. 無線網路設定及驅動程式安裝完成，按「好」繼續安裝程序
Wi-Fi Setting and Driver installation completed, click “Yes” to continue the installation process



26. 按「新增印表機」
Click “Add Printer”



27. 在新增印表機視窗，選擇印表機「Canon G3000 series」(種類為 Canon IJ Network)，確定「使用」為 Canon G3000 series
Choose printer as “Canon G3000 series” (Kind: Canon IJ Network) and make sure “Canon G3000 series” is selected in “Use” column



28. 再次回到「新增印表機」畫面，按「下一步」
Return to “Add Printer” screen again, click “Next”



29. 安裝完成後建議可按「執行」列印測試頁，如發生列印錯誤需重新安裝
After installation, please click “Execute” for printing test page. If problem occurs, you may need to re-install driver



30. 驅動程式安裝完成，安裝軟件請按「下一步」
Driver installation complete, click “Next” to install software



