

在MAC OSX以有線網路接駁安裝MG7770驅動程式步驟 (以OSX 10.10作示範)
MG7770 printer driver Installation Guide for MAC OSX (Via LAN) (OSX 10.10 as example)

把以太網路線連接印表機，並於印表機上作以下設定：
Plug LAN cable to printer, and follow instruction setting:

1. 確保本機已開啟。滑動主頁螢幕  按設定(Setup)，按  設備設定 (Device settings)
Make sure machine is turned on. Flick the HOME screen tap Setup , then tap Device settings 
2. 按LAN設定
Tap LAN settings
3. 按變更LAN(Change LAN)
Tap Change LAN
4. 按啟用有線LAN (Activate wired LAN)
Tap Activate wired LAN

點擊以下連結下載有關之驅動程式：

<http://ugp01.c-ij.com/ij/webmanual/WebPortal/PTL/ptl-setup.html?lang=tc&type=setup&area=hk&model=mg77&os=m>

Click below link for download printer driver:

<http://ugp01.c-ij.com/ij/webmanual/WebPortal/PTL/ptl-setup.html?lang=en&type=setup&area=hk&model=mg77&os=m>

下載及安裝步驟

1. 按一下「下載」。下載完成後開啟該檔案安裝，點擊「Setup」
Click “Download”, open the file after download completed, click “Setup”

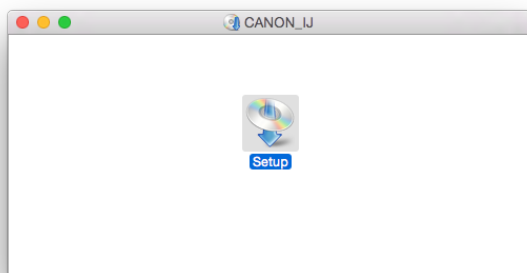

- 按「下一步」
Click “Next”



- 按「開始設定」
Click “Start setup”



4. 選擇「亞洲」、「香港特別行政區」，按「下一步」
Select “Asia”, “Hong Kong SAR China”, click “Next”

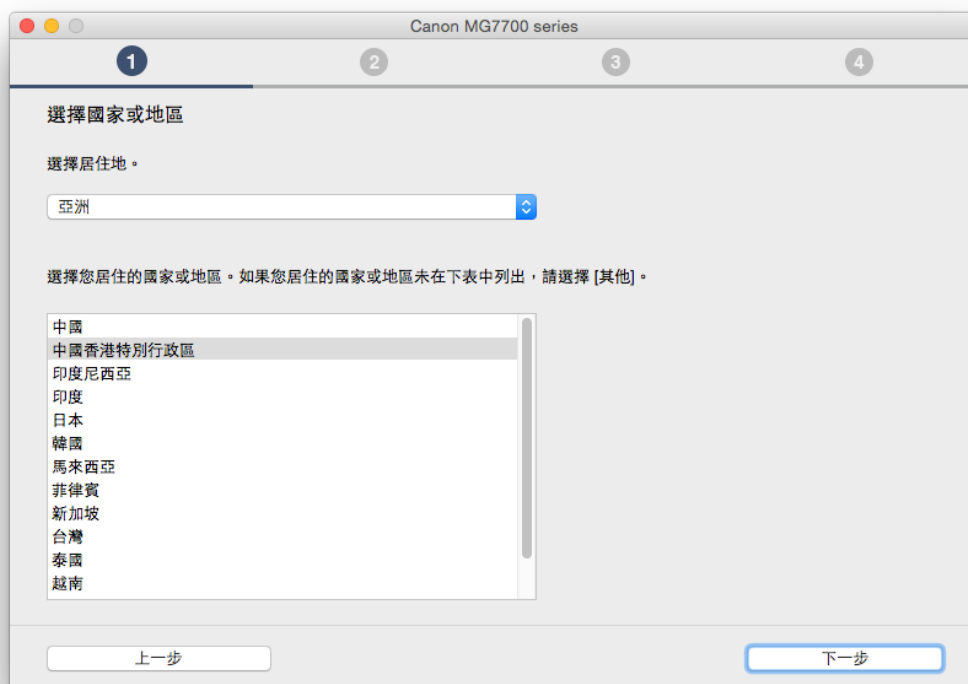

5. 按「是」
Click “Yes”

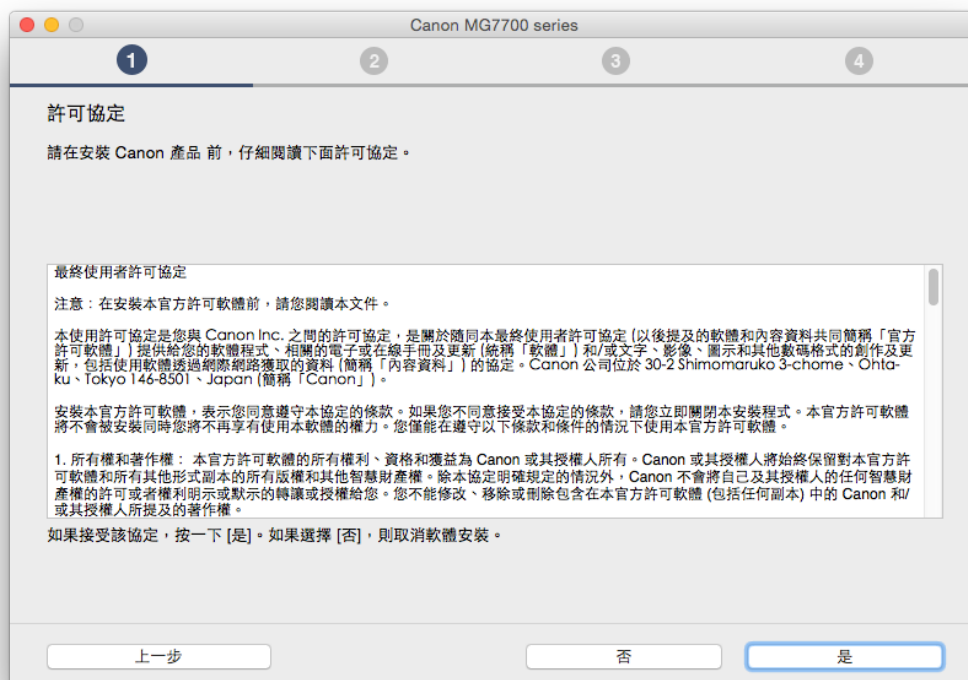

6. 可選擇是否同意作傳送資訊至Canon
Select “Agree” or “Disagree” send information to Canon Extended Survey Program

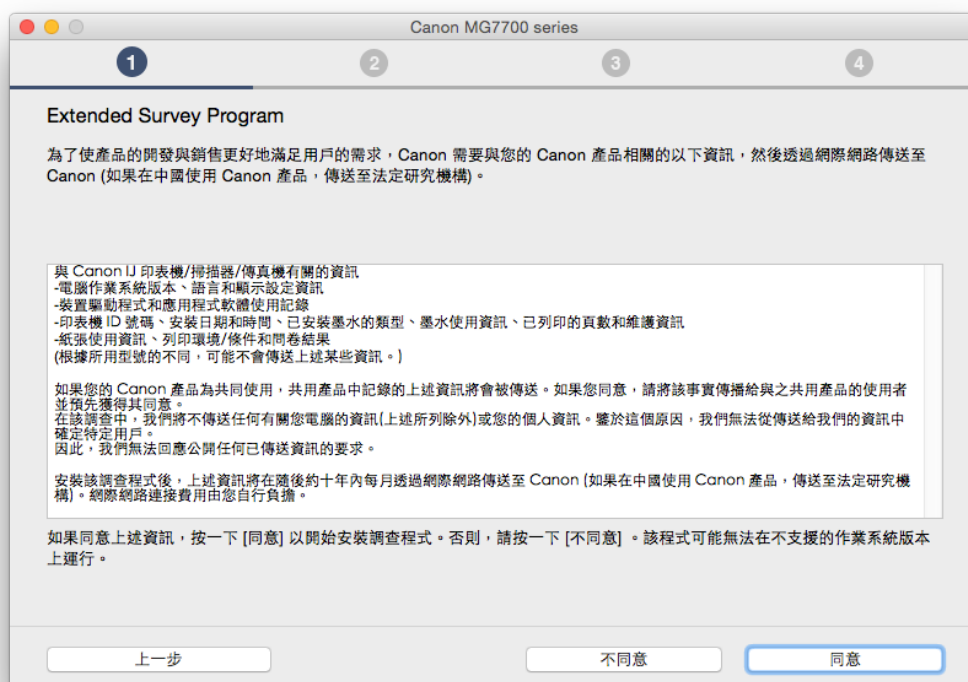

7. 選擇「有線LAN連接」，按「下一步」
Select “Wired LAN Connection”, click “Next”



8. 按「下一步」
Click “Next”

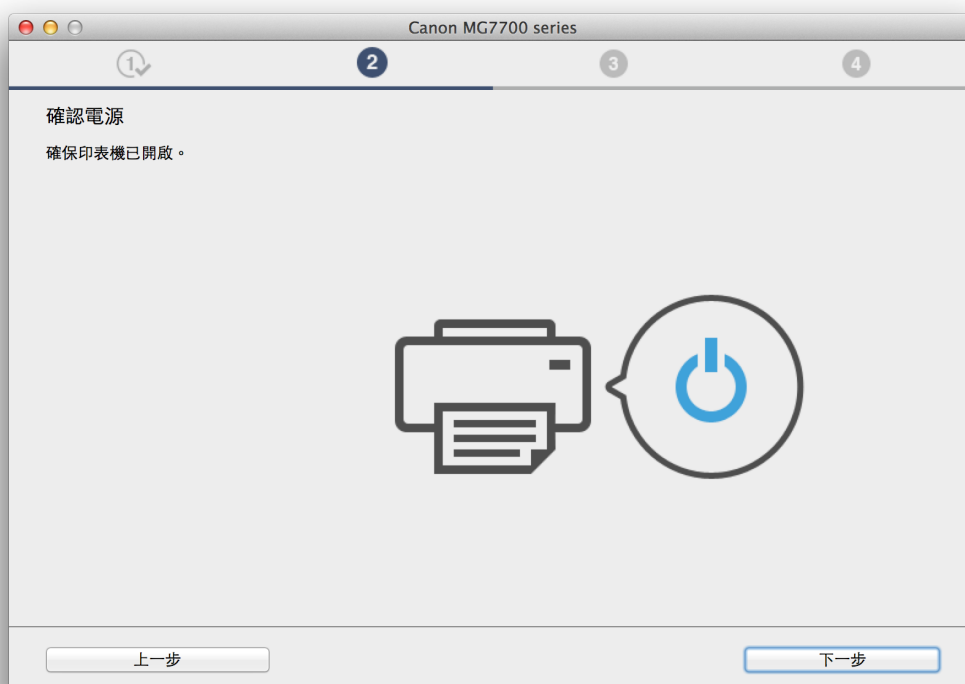

9. 確定印表機已開啟及連接網路，在「網路上印表機的清單」勾選印表機，按「下一步」
Make sure printer is on and connected to network, select printer at “Printers on Network List” then click “Next”

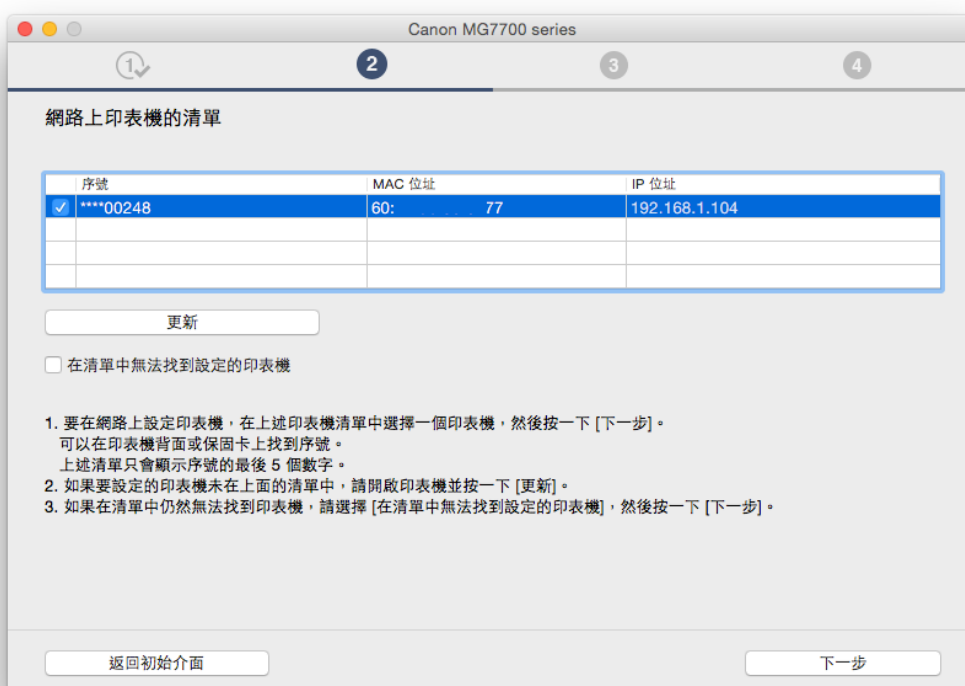

10. 等待電腦下載及安裝驅動程式
Waiting for complete download and install printer driver



11. 按「新增印表機」
Click "Add Printer"



12. 在新增印表機視窗，選擇印表機「Canon MG7700 series」（種類為Canon IJ Network），確定使用「Canon MG7700 series」
Choose name “Canon MG7700 series” (Kind: Canon IJ Network), make sure “Canon MG7700 series” in Use column



13. 再次回到此畫面，按「下一步」
Return to this windows again, click “Next”



14. 安裝完成後建議可按「執行」列印測試頁，如發生列印錯誤需重新安裝
After installation can click “Execute” for print test page, if problem occur may need to re-install driver



15. 驅動程式安裝完成，安裝軟件請按「下一步」
Driver installation complete, click “Next” for install software

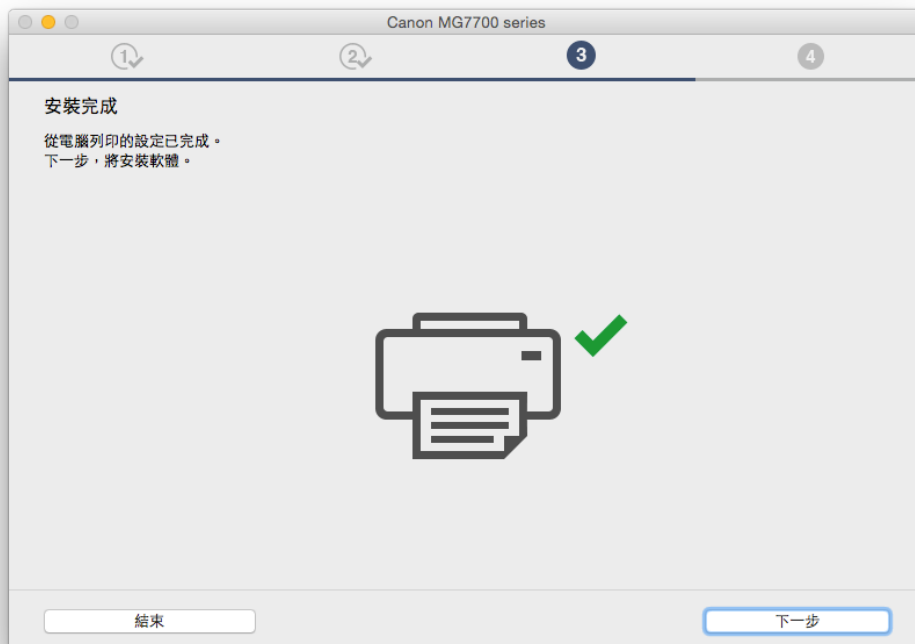

16. 在軟體安裝清單勾選所需軟件，按「下一步」
Select software need and click “Next”

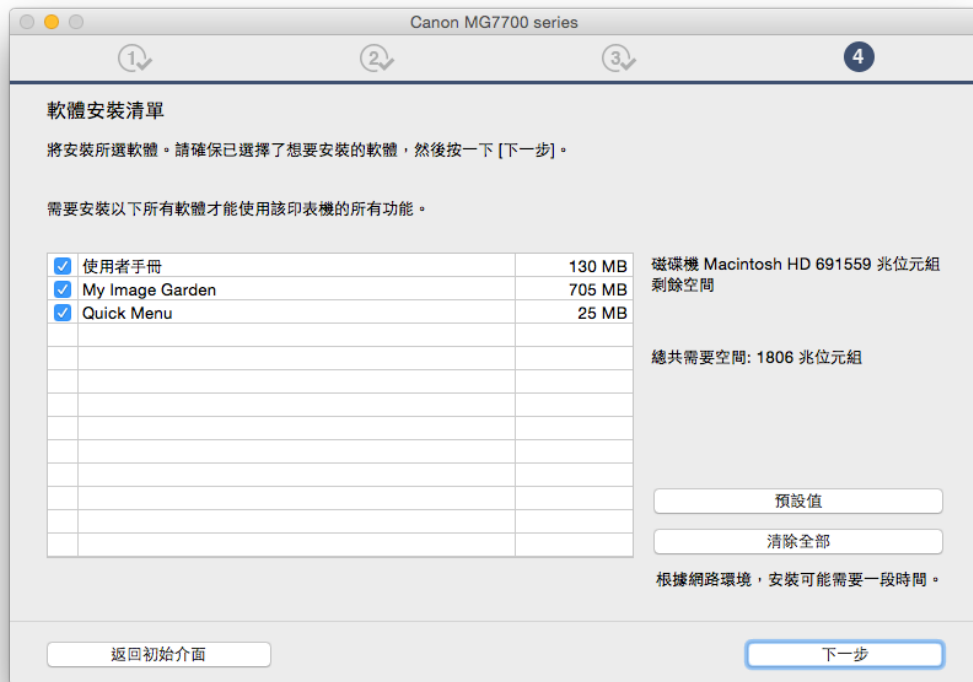

17. 按「結束」完成安裝
Click “Finish” to complete installation



-完-
-End-